

**J!2241414031**

**J5 @J9 'D5 F HGž5 GG9 A 6 @M'5 B8 '  
A CI BH-B; 'B GHFI 7 H-CBG**



**F958 'H<9G9 'B GHFI 7 H-CBG'H<CFCI ; <@M**

**K 9 GH9 B8 CF: 'A: ; "7 C" B7 "**

UPOY OZU Y OZÁ FEI €ÁPUBÓÁĀ FGDÁ GHĀ Ī G

د د د Ĥ ħ^i • B {

# V-2240000000

DR. BY: JLR

DATE: 5/8/02

RN: 1

DATE: 8/14/08

BY: GJS

PAGE: 1 OF 1

REF #	PART #	REV	DESCRIPTION	QTY
1	OC-N2S		VALVE	1
2	VP-76	A	VALVE COVER BRACKET	1
3	PF-PB1210		POWER BEYOND ADAPTER	1
4	PF-PO10		7/8" O-Ring Plug	1
5	MHS08125020		8mm X 20mm - 1.25p BOLT	4
6	SHW1214008		7/32" X 1/2" HEX HEAD SCREW	4

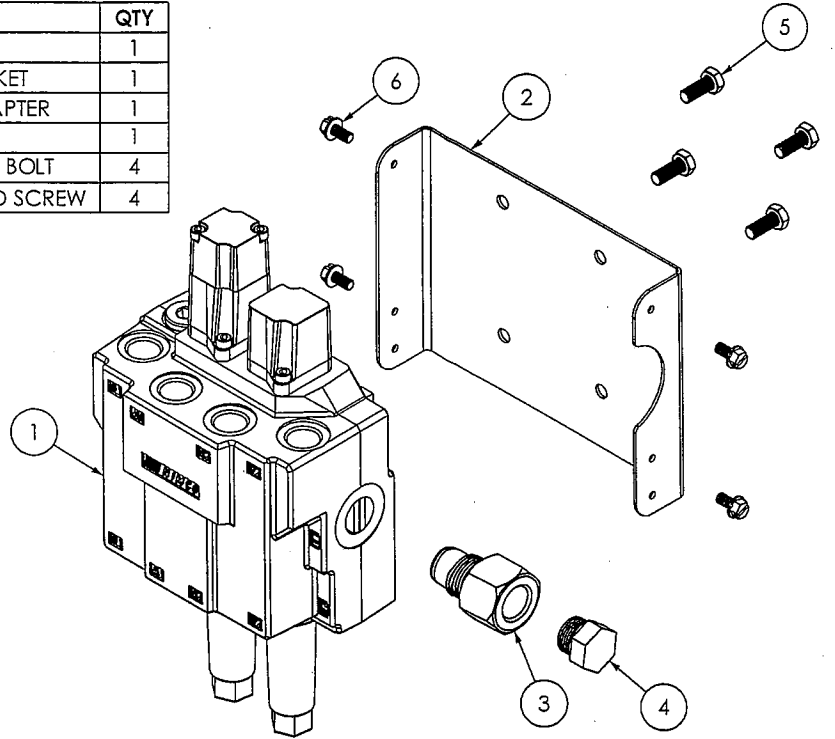

**FOR USE WITH V-0240005000 ONLY**

PART #	REV	DESCRIPTION	QTY
VP-75	-	VALVE COVER	1

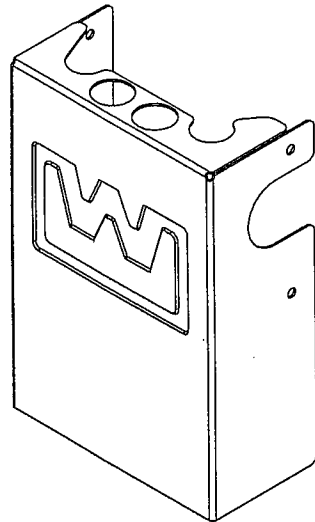

**FOR USE WITH ALL OTHER FITTING KITS**

PART #	REV	DESCRIPTION	QTY
VP-83	A	VALVE COVER	1

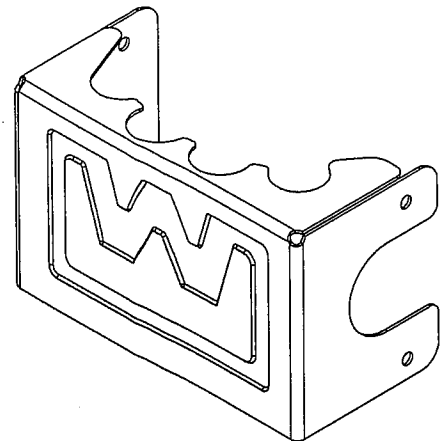

**READ THESE INSTRUCTIONS THOROUGHLY**



**WESTENDORF MFG. CO. INC.**

ONAWA, IOWA 51040 PHONE (712) 423-2762

www.loaders.com

# V-1241400000

## PARTS LIST

DR. BY: STR DATE: 1/5/2001 RN: 0

DATE:

BY:

PAGE: 1 OF 57

REF.	PART NO.	DESCRIPTION	QTY.
1	REMOTE 2J	JOYSTICK	1
2	RM-22	72" CABLE	2
3	RM-93	VALVE ATTACH KIT	2
4	AHS0420012	ALLEN HEAD SCREW 1/4" X 3/4"	4

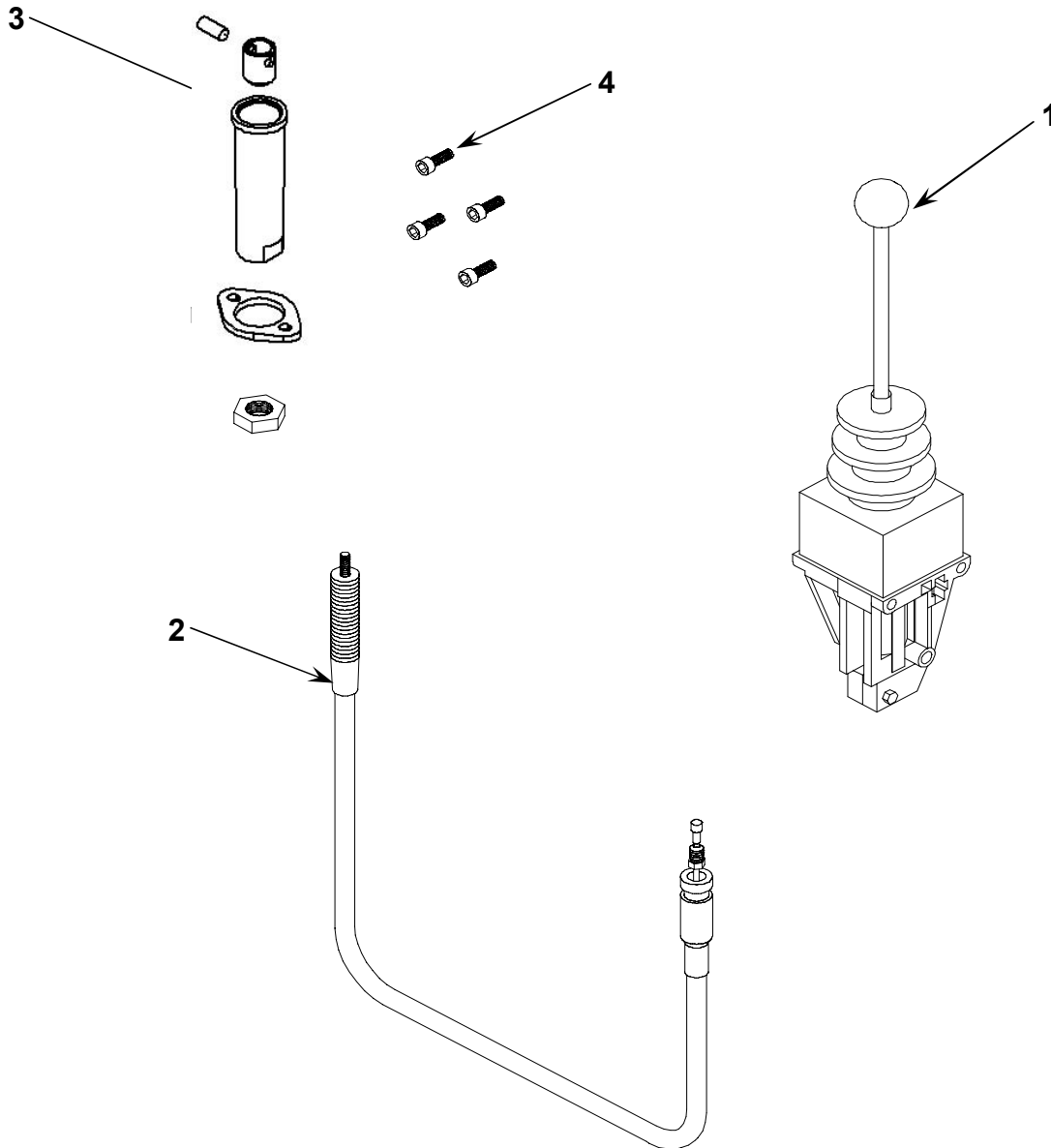

**WESTENDORF MFG. CO. INC.**

ONAWA, IOWA 51040 PHONE (712) 423-2762

# ASSEMBLY INSTRUCTIONS

V-124140000

DATE: 1/5/2001

RN: 0 JLR

PAGE: 2 OF 5

## STEP: 1

### READ OPERATOR'S MANUAL

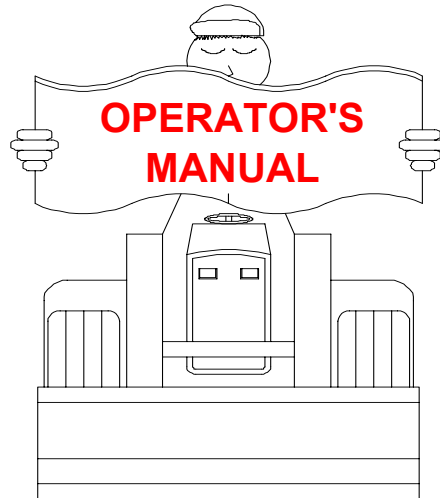

## STEP: 1

- A)** Read through the "Operator's Manual" and "Assembly Instructions" before starting. The more familiar you are with the instructions and operation of the loader the easier it will be to attach the joystick and connect it to the valve.
- B)** If you have trouble, check the Trouble Shooting section in the Operator's Manual.

## STEP: 2

### ATTACH JOYSTICK

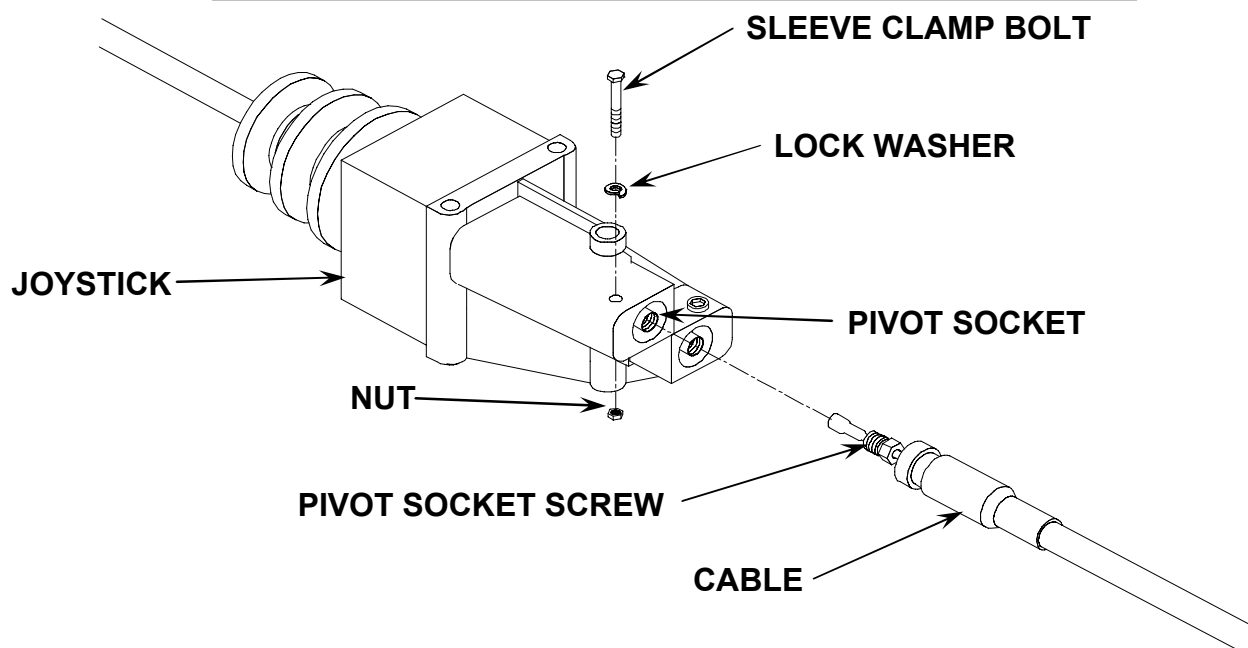

## STEP: 2 (illustration shows bottom of joystick)

- A)** Remove sleeve clamp bolt, lock washer and nut from one side of the bottom of the joystick.
- B)** Screw the pivot socket screw at the end of the cable into the pivot socket on the joystick.

# ASSEMBLY INSTRUCTIONS

V-124140000

DATE: 1/5/2001

RN: 0 JLR

PAGE: 3 OF 5

## STEP: 3

### ATTACH JOYSTICK

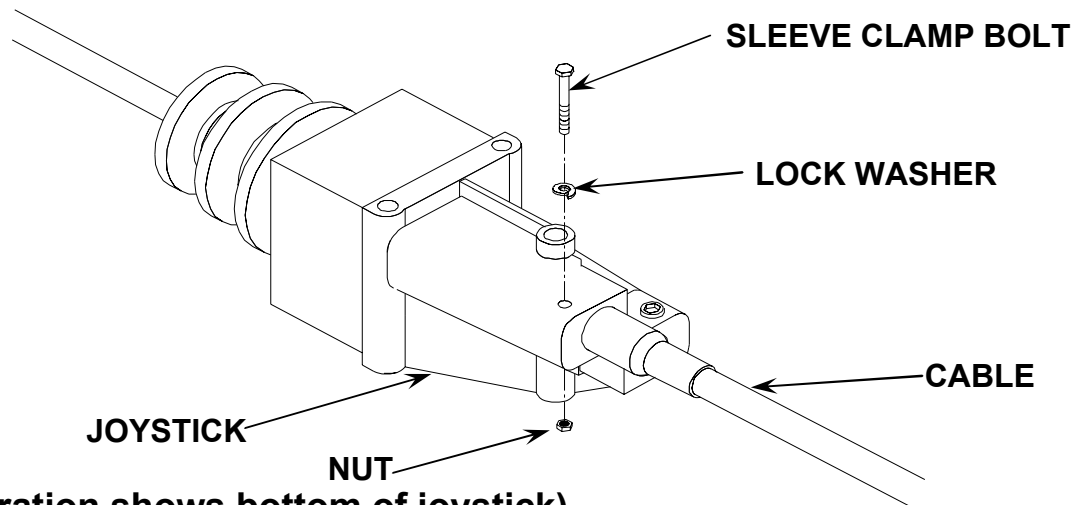

#### STEP: 3 (illustration shows bottom of joystick)

**A)** Insert the cable into the joystick and secure in place with the sleeve clamp bolt, lock washer and nut removed previously.

**B)** Repeat steps two and three for the other side of the joystick.

**C)** Read the mounting instructions for the joystick and valve at the end of this manual.



**IMPORTANT:** Before continuing on to the next step you must first decide where to locate the joystick and valve. Modifications to the tractor may be necessary before proceeding.

## STEP: 4

### PREPARE CABLE

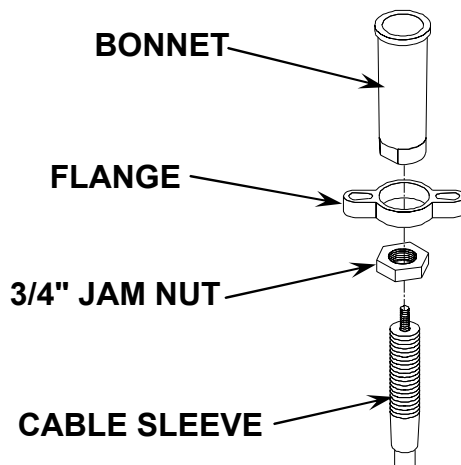

#### STEP: 4 (illustration shows cable end)

**A)** Run the cable from the chosen location of the joystick to the chosen location of the valve.

**B)** Place the jam nut, flange and bonnet on the cable, as show, by screwing them on to and past the cable sleeve.

# ASSEMBLY INSTRUCTIONS

V-124140000

DATE: 1/5/2001

RN: 0 JLR

PAGE: 4 OF 5

STEP: 7

## ADJUST CABLES

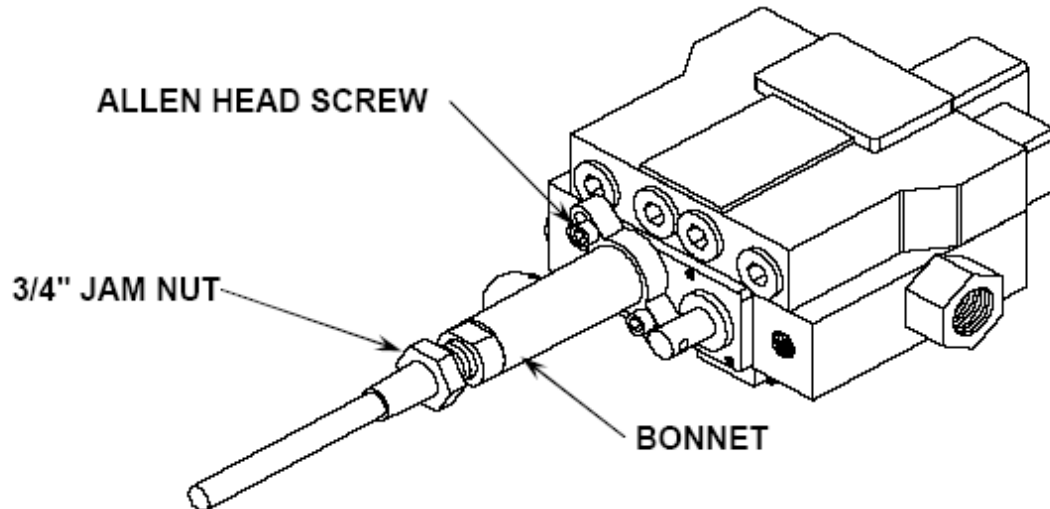

**STEP: 7 (illustration shows left spool; repeat step for right spool)**

- A)** Adjust the joystick control by turning the bonnet to loosen or tighten the cable. Watch the joystick while turning the bonnets making sure the joystick stays centered.
- B)** Check the joystick and valve for float operation. Once the joystick is set properly tighten the two allen head screws and tighten the 3/4" jam nut on to the bonnet.

STEP: 8

## ASSEMBLY COMPLETE

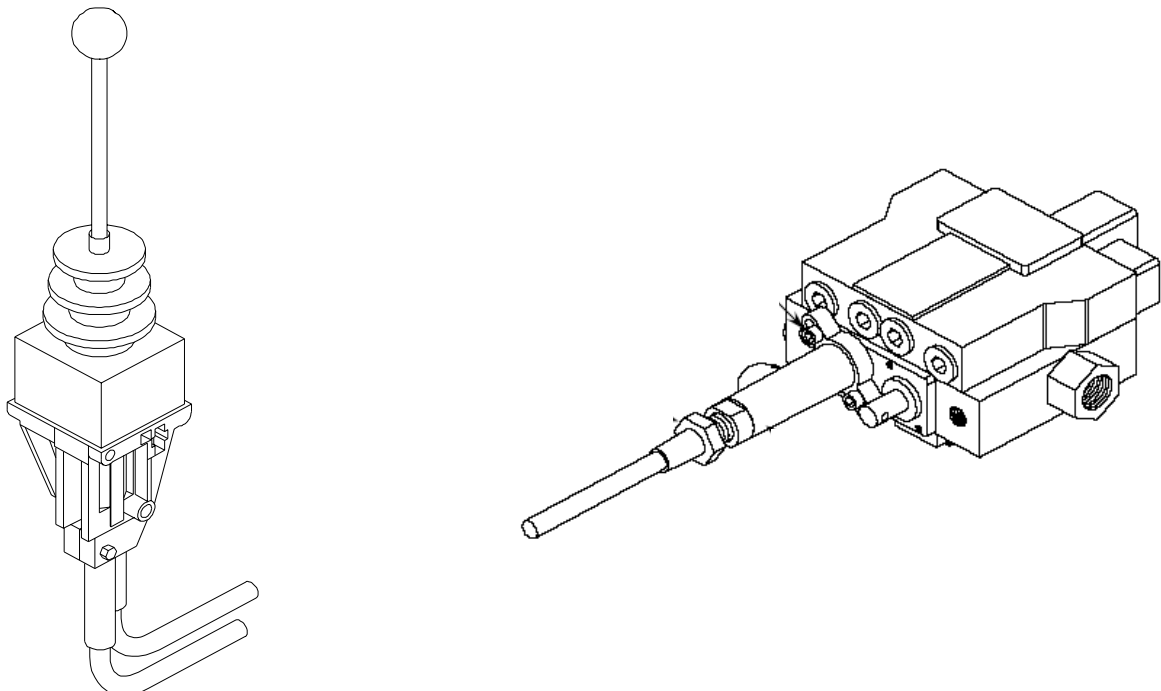

STEP: 8

- A)** Assembly complete.

# ASSEMBLY INSTRUCTIONS

V-124140000

DATE: 1/5/2001

RN: 0 JLR

PAGE: 5 OF 5

STEP: 9

## RECOMMENDED OPERATION

LEFT TO ROLL BACK

FORWARD TO LOWER  
(FLOAT POSITION)

BACK TO LIFT

RIGHT TO DUMP

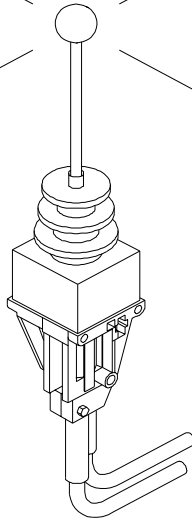

STEP: 9

A) These are the recommended operating positions for the joystick control.

**NOTE:** When hooking up the loader you may need to move the hoses around until the loader operates the way you want it to.

# V-0240014000

DR. BY: GJS

DATE: 8/13/08

RN:

DATE:

BY:

PAGE: 1 OF 4

REF #	PART #	DESCRIPTION	QTY
1	PF-OS08	SWIVEL ADAPTER	2
2	PF-OS0806	SWIVEL ADAPTER	4

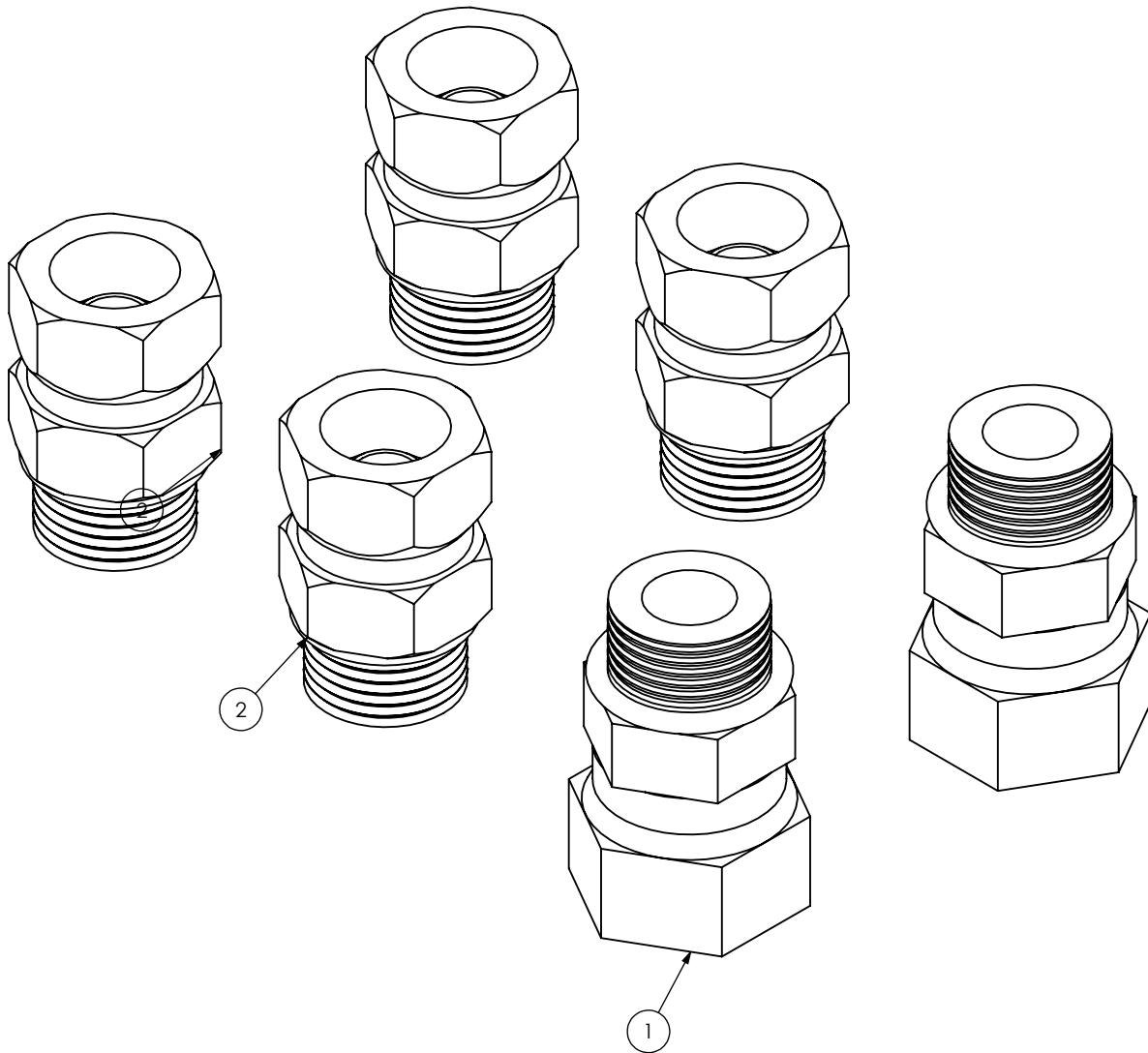

**READ THESE INSTRUCTIONS THOROUGHLY**



**WESTENDORF MFG. CO. INC.**

ONAWA, IOWA 51040 PHONE (712) 423-2762

[www.loaders.com](http://www.loaders.com)



# ASSEMBLY INSTRUCTIONS

V-0240014000

DR. BY: GJS

DATE: 8/13/08

RN:

DATE:

BY:

PAGE: 2 OF 4

## ATTACH SWIVELS

REF #	DESCRIPTION	QTY
1	VALVE	1
2	90° SWIVEL ELBOW	1
3	POWER BEYOND ADAPTER	1
4	SWIVEL ADAPTER	4
5	HEX HEAD PLUG	1
6	O-RING HEX HEAD PLUG	1

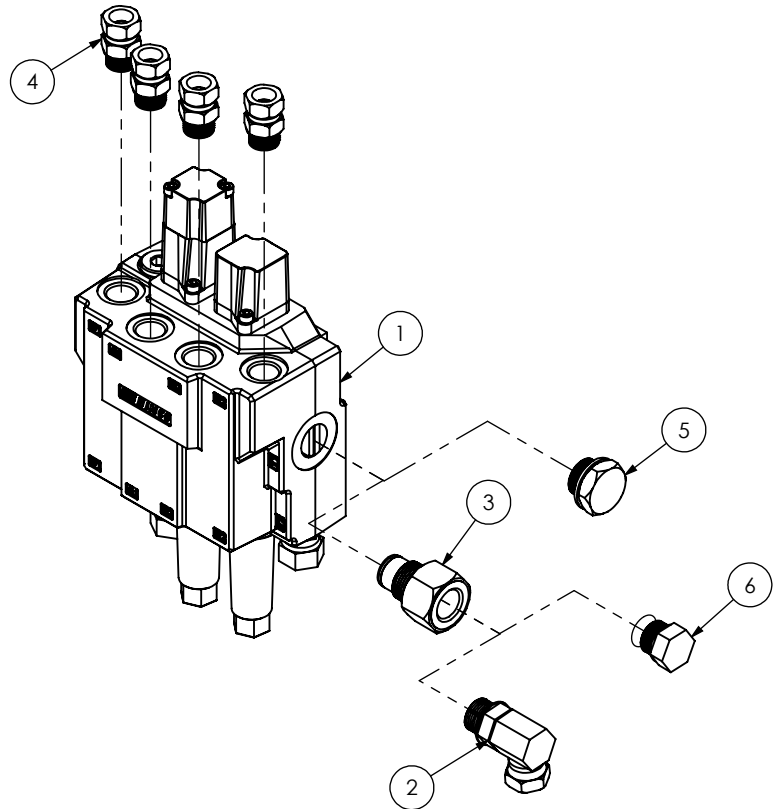

### STEP 1:

- A) Attach four 3/4" X 3/8" swivel adapters to the valve, as shown
- B) **WITHOUT POWER BEYOND**, Remove the power beyond adapter from the valve, and replace it with the hex head plug provided, as shown.
- C) **WITH POWER BEYOND**, attach the power beyond adapter and one 90° swivel elbow to the valve, as shown.
- D) **FOR CLOSED CENTER**, Attach the power beyond adapter and one O-ring hex head plug to the valve, as shown.

## ATTACH SWIVELS

REF #	DESCRIPTION	QTY
1	VALVE	1
2	SWIVEL ADAPTER	2

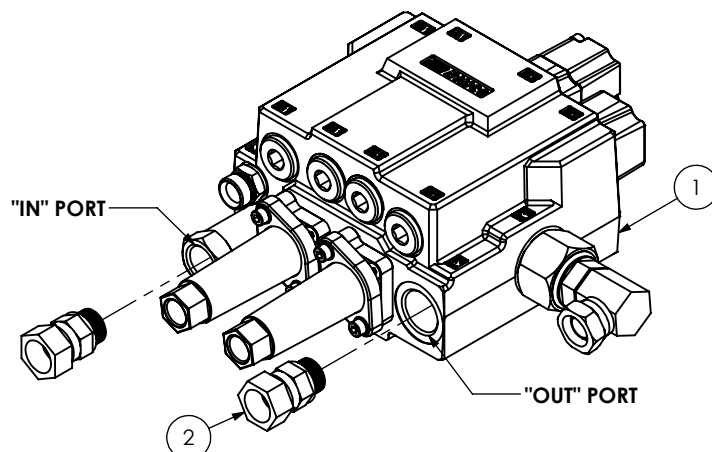

### STEP 2:

- A) Attach two 3/4" X 1/2" swivels to the "IN" port and the "OUT" port of the valve, as shown.

# MOUNTING INSTRUCTIONS

V-0240014000

DR. BY: GJS

DATE: 8/13/08

RN:

DATE:

BY:

PAGE: 3 OF 4

## VALVE HOSE HOOKUP

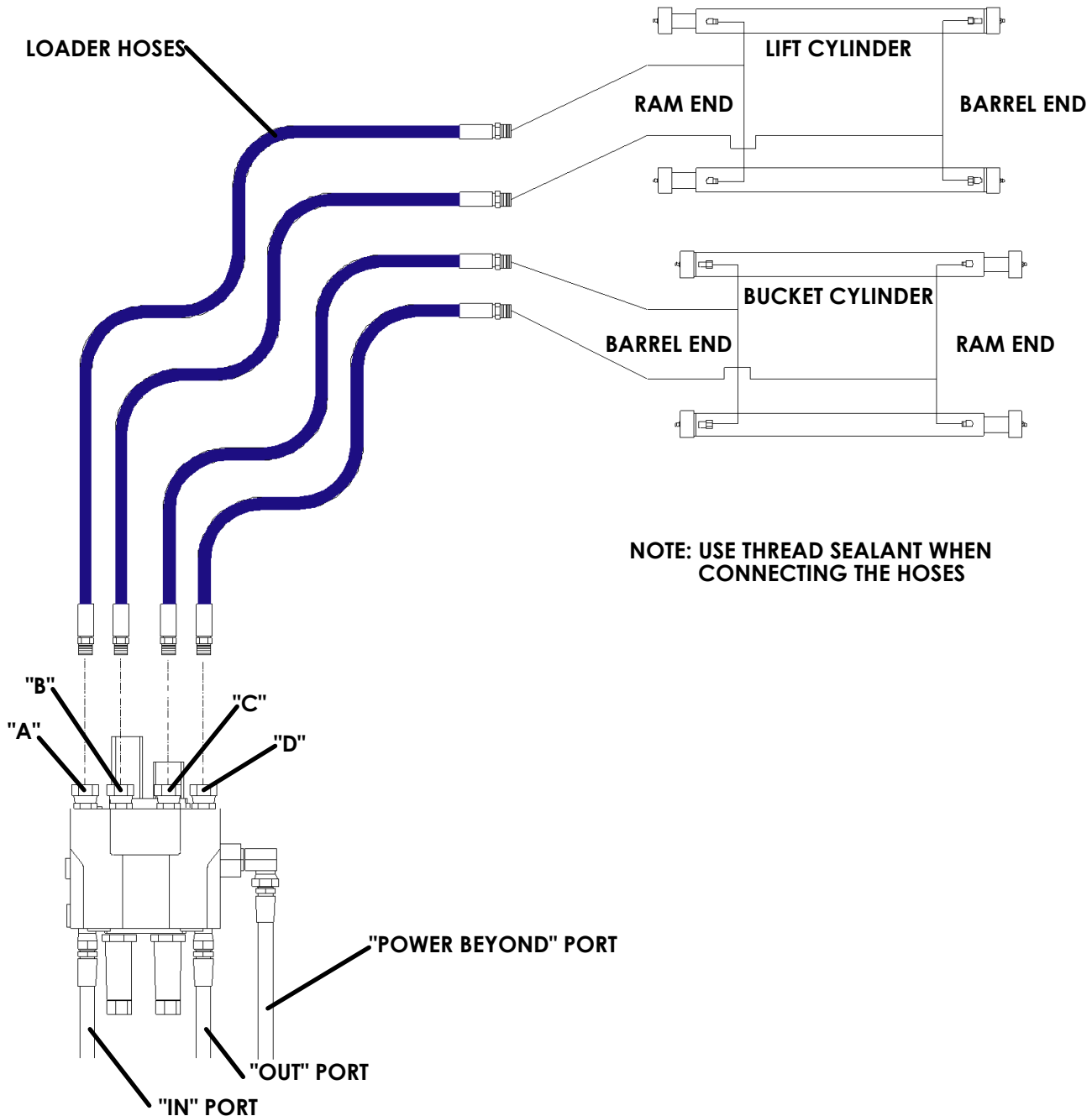

NOTE: USE THREAD SEALANT WHEN CONNECTING THE HOSES

### STEP 3:

- Connect the proper hoses to the loader, in the "IN" port, "OUT" port, and the "POWER BEYOND" port (if equipped) as shown, in the diagram above. **See your bracket mounting instructions for hose lengths.**
- Connect each of the hoses to the valve, as follows.
  - Connect port "A" to the ram end of the lift cylinder
  - Connect port "B" to the barrel end of the lift cylinder
  - Connect port "C" to the barrel end of the bucket cylinder
  - Connect port "D" to the ram end of the bucket cylinder



**CAUTION:** When hooking up the hydraulics make sure fittings are clean to prevent any foreign material from contaminating or damaging the system.

# MOUNTING INSTRUCTIONS

V-0240014000

DR. BY: GJS

DATE: 8/13/08

RN:

DATE:

BY:

PAGE: 4 OF 4

## RECOMMENDED OPERATION

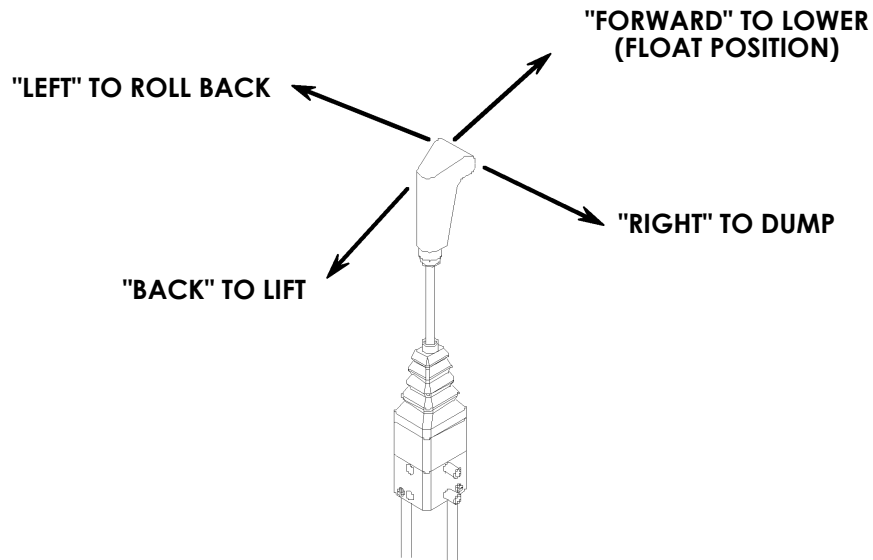

### STEP 4:

A) These are recommended operating positions for the joystick control.

**NOTE:** When hooking up the loader you may need to move the hoses around until the loader operates the way you want it to.

# V-0000000031

DR. BY: STR

DATE: 07/07/21

RN: 1

DATE:

BY:

PAGE: 1 OF 7

REF #	PART #	REV	DESCRIPTION	QTY
1	VP-85	--	VALVE PLATE	1
2	VJ-104	--	VALVE BRACKET PIPE	1
3	VP-1-01	--	CONTROL STAND	1
4	VP-1-02	--	CONTROL STAND BASE	1
5	HHS0518016	--	5/16" X 1" BOLT	4
6	HHS0518064	--	5/16" X 4" BOLT	3
7	LWM05	--	5/16" LOCK WASHER	4
8	HFN0518	--	5/16" NUT	4
9	HTN0518	--	5/16" LOCK NUT	3

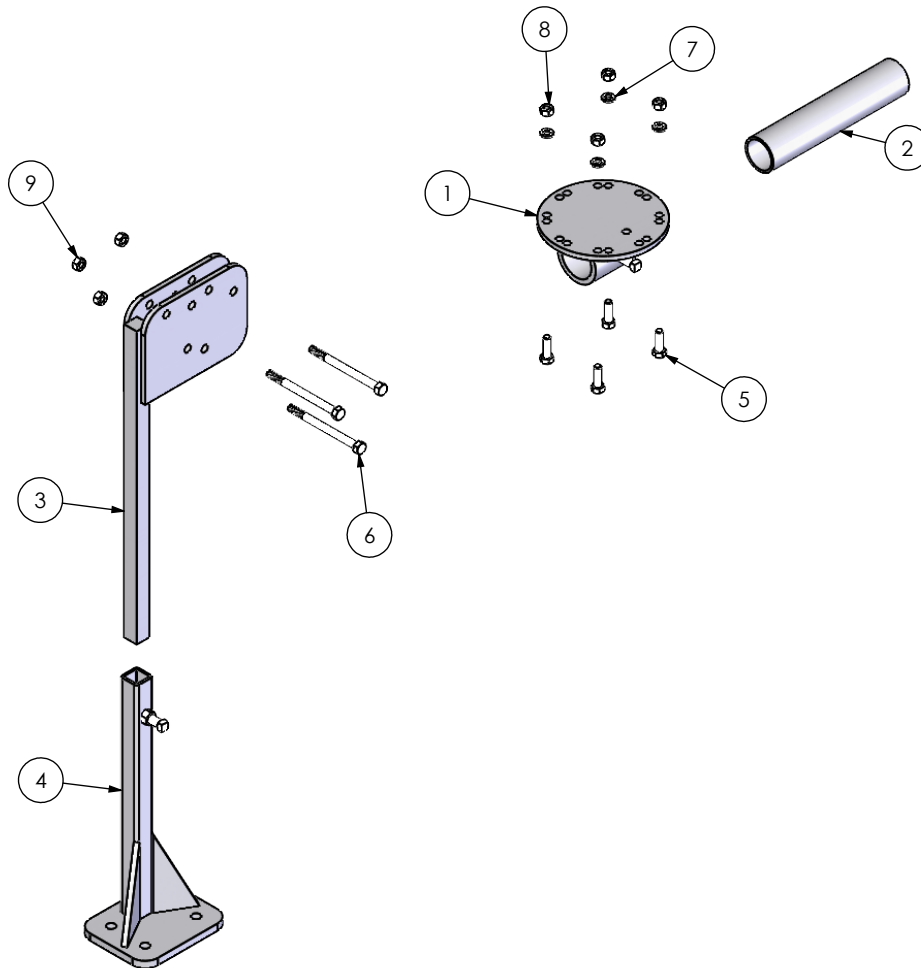

**READ THESE INSTRUCTIONS THOROUGHLY**



**WESTENDORF MFG. CO. INC.**

ONAWA, IOWA 51040 PHONE (712) 423-2762

[www.loaders.com](http://www.loaders.com)

# MOUNTING INSTRUCTIONS

V-000000031

DR. BY: STR

DATE: 07/07/21

RN: 1

DATE:

BY:

PAGE: 2 OF 7

## PREPARATION

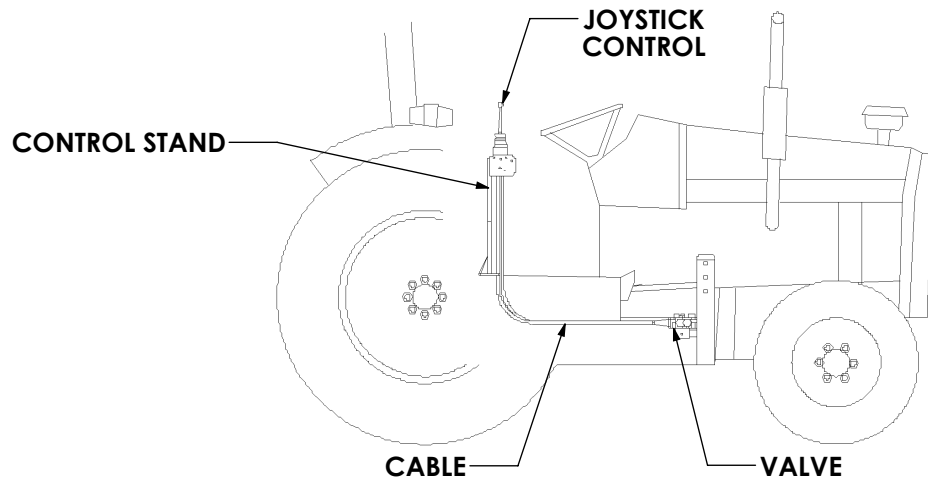

A) Examine the tractor for possible locations for the valve and joystick control.

**NOTES:** Choose a location that will protect the valve and allow the hoses and cables to be connected. The location should protect the cables from heat above 225° F and physical damage such as crushing or pinching. Choose a location for the cables to pass through the floor board (if necessary) being careful not to damage anything under the floor such as electrical wires or oil lines.

## CHOOSE JOYSTICK LOCATION

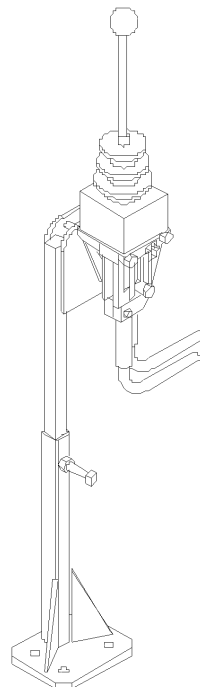

A) Choose a convenient and comfortable place to mount the joystick control.

The joystick control is shown mounted on the Westendorf control stand however you may choose to mount the control along the side of the cab, in the console, or some other convenient spot.

# MOUNTING INSTRUCTIONS

V-000000031

DR. BY: STR

DATE: 07/07/21

RN: 1

DATE:

BY:

PAGE: 3 OF 7

## ATTACH JOYSTICK

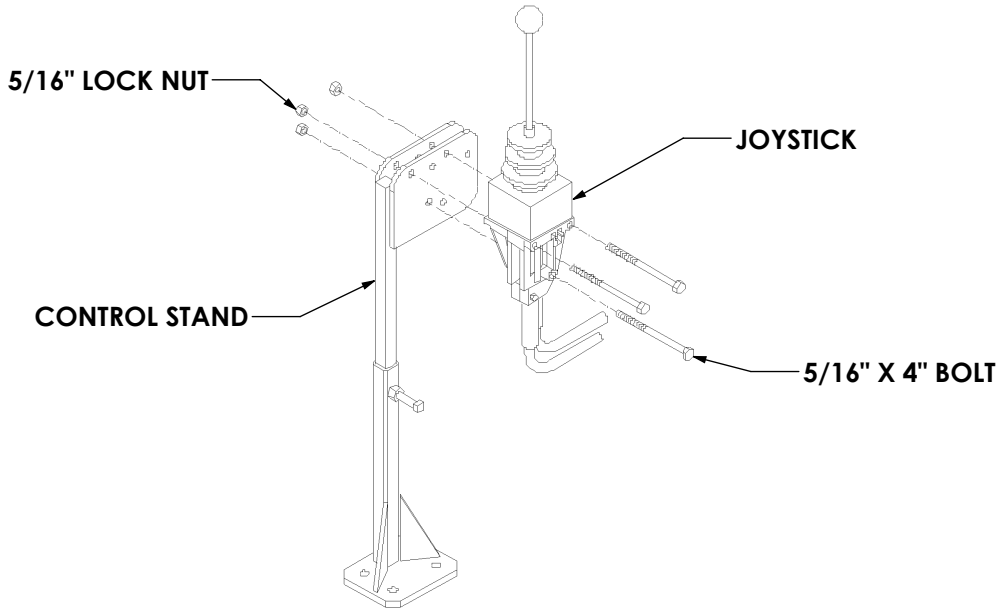

- A) Attach the joystick to the control stand, as shown, using three 5/16" X 4" bolts and lock nuts provided.
  - B) Attach the bottom of the stand to the floor of the cab. Be careful not to damage anything under the floor such as electrical wires and oil lines.
  - C) Run the cables from the joystick to the desired valve location.
- NOTE:** Your joystick control may look different than the one shown but will attach the same.

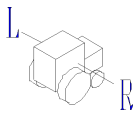

## CHOOSE VALVE LOCATION

### FRONT OF TRACTOR

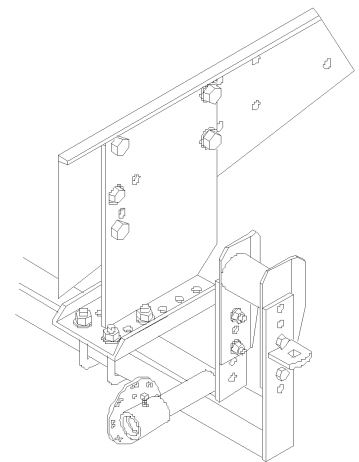
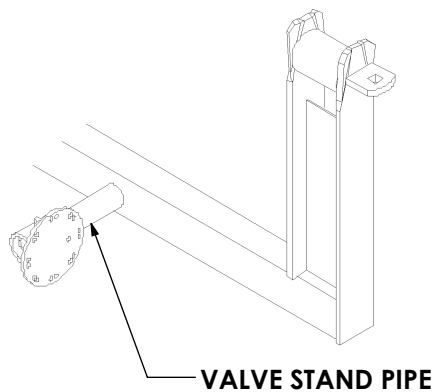
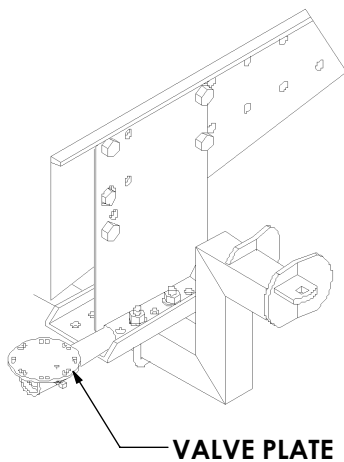

- A) Mount your valve outside the cab in a location that will protect the valve from damage and will allow all the hoses and cables to be hooked up. This step may require some creativity on your part. Shown are a few examples of how the valve plate, and valve stand pipe can be mounted.

# ASSEMBLY INSTRUCTIONS

V-000000031

DR. BY: STR

DATE: 07/07/21

RN: 1

DATE:

BY:

PAGE: 4 OF 7

## ATTACH VALVE

2 SPOOL PRECISION  
VALVE ONLY

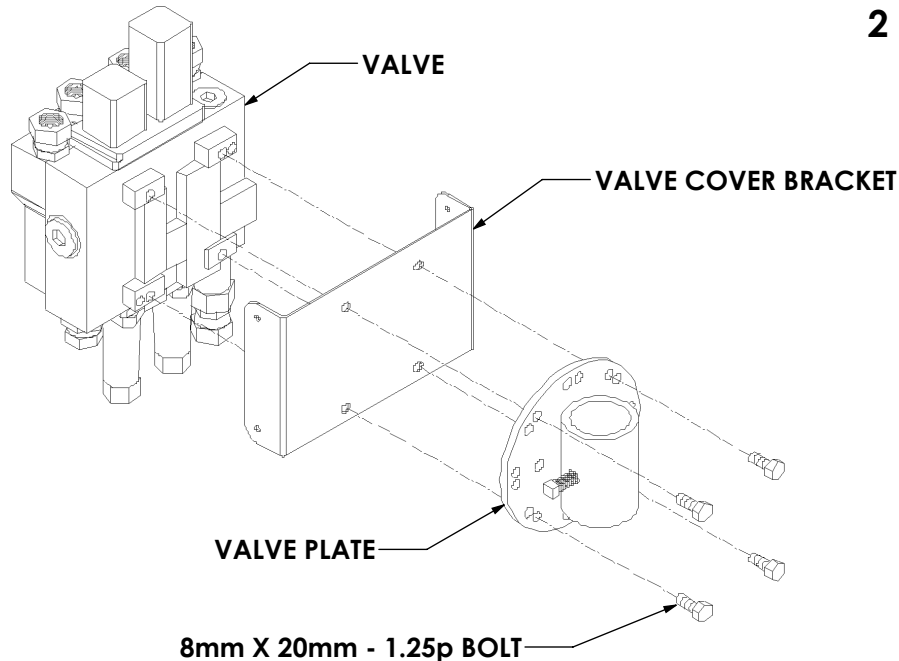

A) Attach the valve and the valve cover bracket to the valve plate, as shown, using four 8mm X 20mm - 1.25p bolts provided.

**NOTE:** The valve can be mounted in several different positions on the valve plate. Consider your hose lengths and joystick location when determining which holes to mount your valve.

## ATTACH VALVE COVER

2 SPOOL PRECISION  
VALVE ONLY

7/32" X 1/2" SLOTTED  
HEX HEAD SCREW

VALVE COVER

VALVE COVER BRACKET

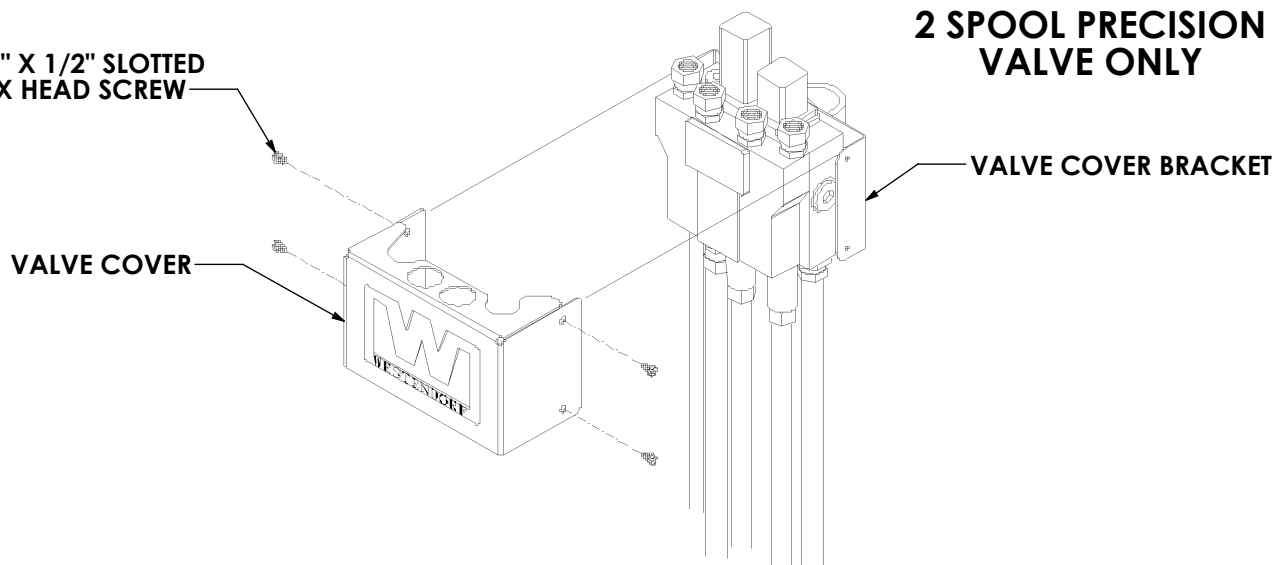

A) Place the valve cover on to the valve so that the two swivel adapters in the middle of the valve go through the two holes in the top of the valve cover.

B) Attach the valve cover to the valve cover bracket, as shown, using four 7/32" X 1/2" slotted hex head screws.

# ASSEMBLY INSTRUCTIONS

V-000000031

DR. BY: STR

DATE: 07/07/21

RN: 1

DATE:

BY:

PAGE: 5 OF 7

## ATTACH VALVE PLATE

2 SPOOL WITH ELECTRIC 3rd  
FUNCTION VALVES  
2 SPOOL WITH ELECTRIC 3rd AND  
4th FUNCTION VALVES

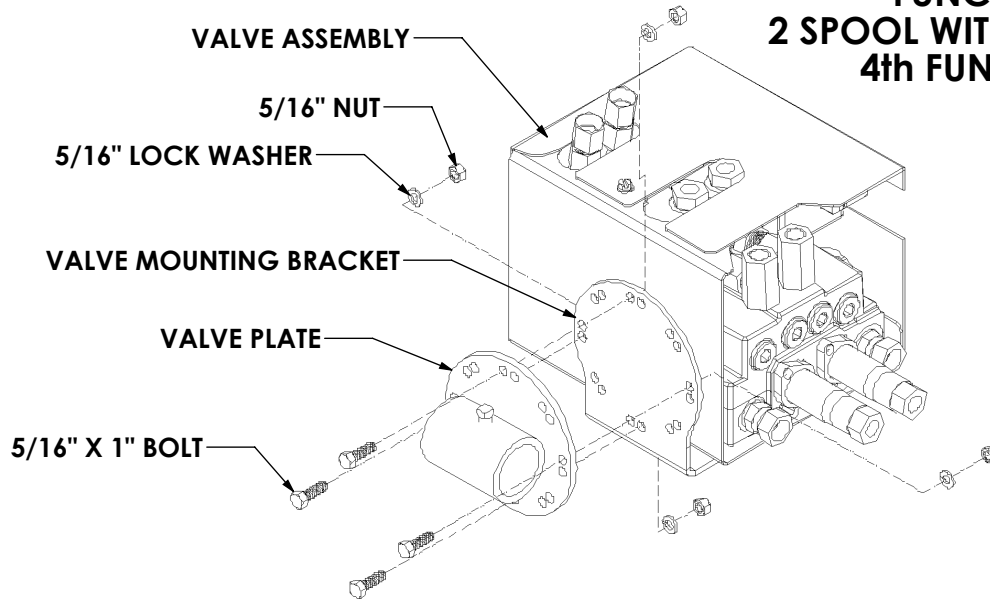

A) Attach the valve plate to the valve mounting bracket, as shown, using four 5/16" X 1" bolts, lock washers, and nuts provided.

**NOTE:** The valve can be mounted in several different positions on the valve plate. Consider your hose lengths and joystick location when determining which holes to mount your valve.

## ATTACH VALVE PLATE

2 SPOOL PRECISION INLINE  
WITH LEVEL UP ADDED ONLY

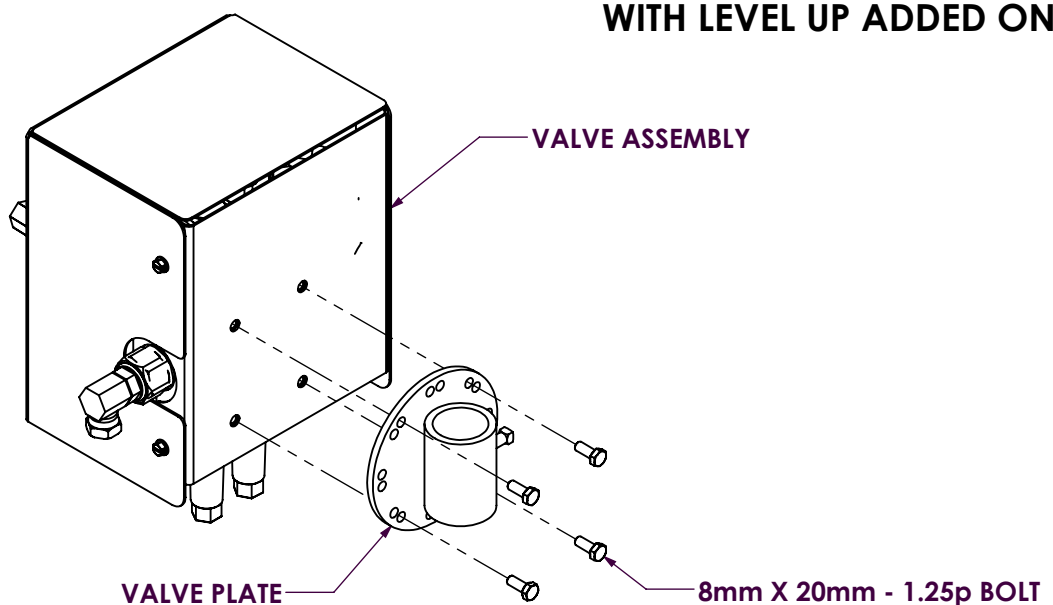

A) Attach the valve plate to the valve cover, as shown, using four 8mm X 20mm - 1.25p bolts provided.

**NOTE:** The valve can be mounted in several different positions on the valve plate. Consider your hose lengths and joystick location when determining which holes to mount your valve.



# ASSEMBLY INSTRUCTIONS

V-000000031

DR. BY: STR

DATE: 07/07/21

RN: 1

DATE:

BY:

PAGE: 6 OF 7

## ATTACH VALVE

**2 SPOOL PRECISION  
VALVE ONLY**

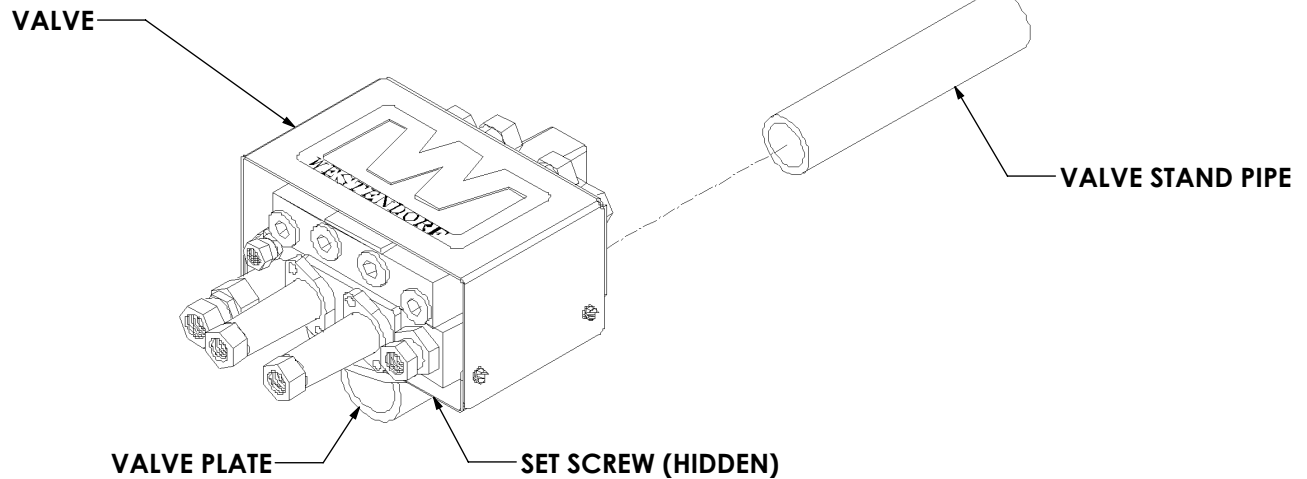

A) Attach the valve plate to the valve stand pipe, as shown, by sliding the pipe into the bushing on the bottom of the valve plate and tightening the set screw.

## ATTACH VALVE

**2 SPOOL WITH ELECTRIC 3rd  
FUNCTION VALVES  
2 SPOOL WITH ELECTRIC 3rd AND  
4th FUNCTION VALVES**

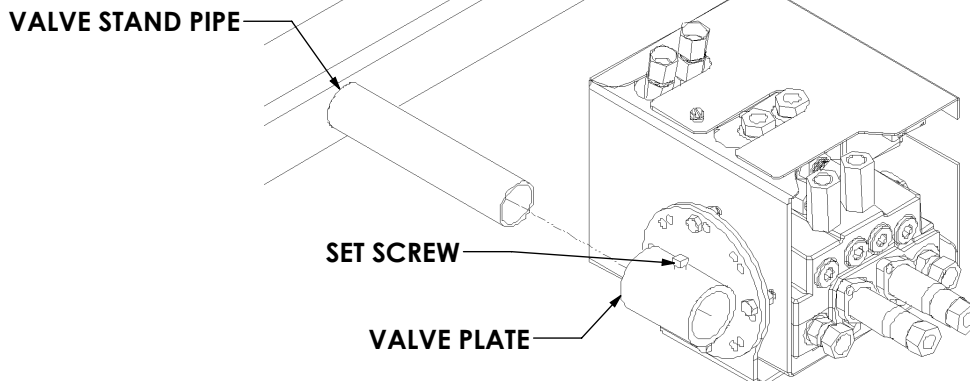

A) Attach the valve plate to the valve stand pipe, as shown, by sliding the pipe into the bushing on the bottom of the valve plate and tightening the set screw.

# ASSEMBLY INSTRUCTIONS

V-000000031

DR. BY: STR

DATE: 07/07/21

RN: 1

DATE:

BY:

PAGE: 7 OF 7

## ATTACH VALVE

2 SPOOL PRECISION INLINE  
WITH LEVEL UP ADDED ONLY

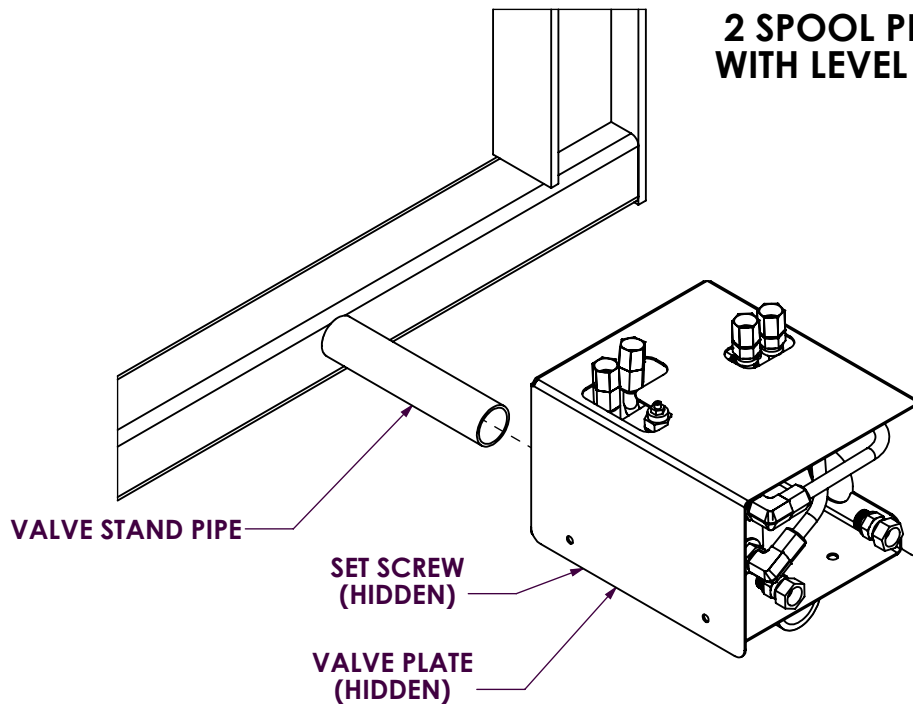

A) Attach the valve plate to the valve stand pipe, as shown, by sliding the pipe into the bushing on the bottom of the valve plate and tightening the set screw.