

- NOTES: 1.) MAT'L - 1x2-1/2 5160 FLAT
 HARDNESS - ROCKWELL C42-46
 2.) FINISH - PAINT BLACK.
 3.) PART MUST BE SHOT PEENED TO ALMEN C-7 MINIMUM IN THE AREA INDICATED

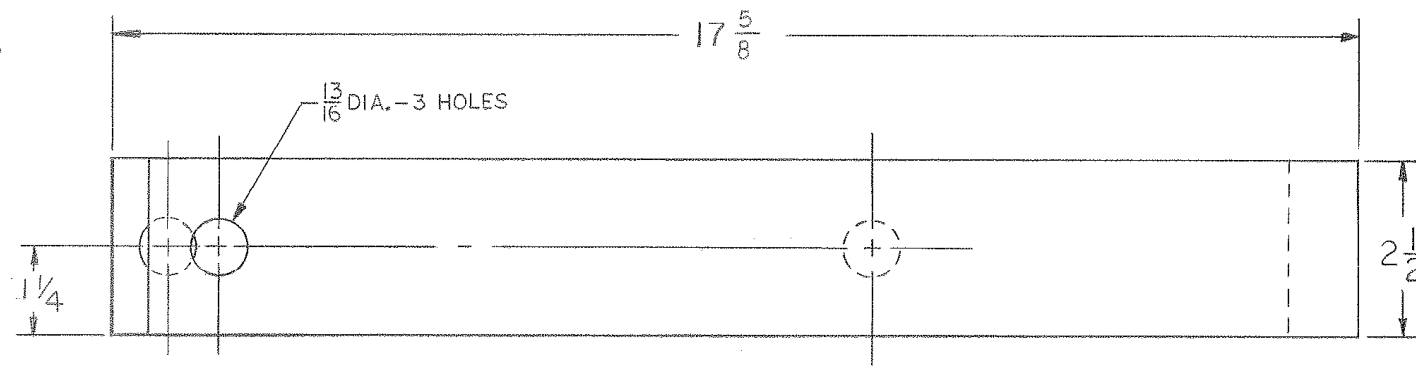

TOP VIEW

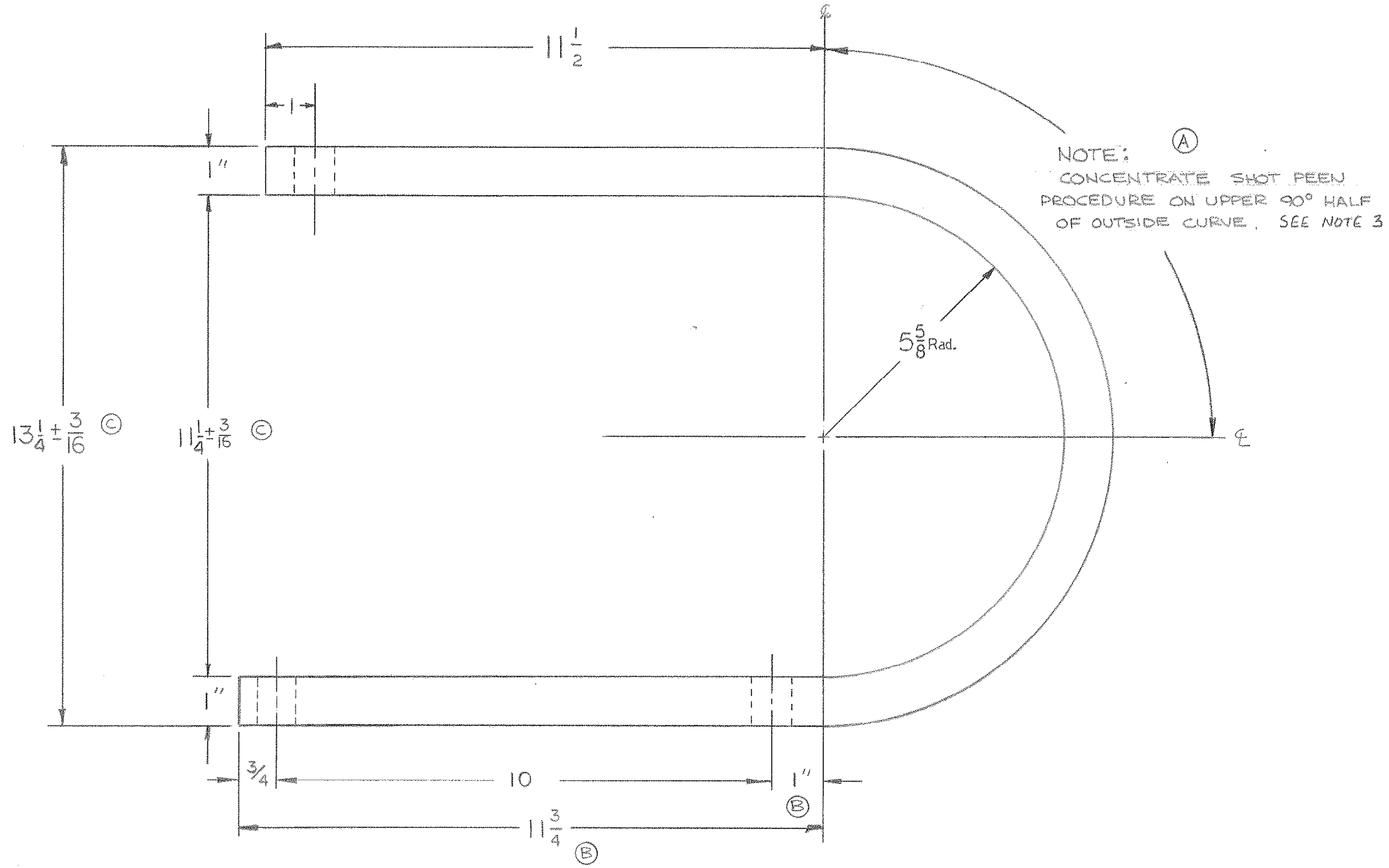

SIDE VIEW

DRAWING NO. 41430 1/1

WIL-RICH FARM EQUIPMENT DIVISION LEAR SIEGLER, INC.	THIS PART NUMBER SUPERSEDES PREVIOUSLY ASSIGNED	P/N 25706
	MAT'L PPP	

HUTCHINSON DIVISION LEAR SIEGLER, INC.		CLAY CENTER, KANSAS 67432	
DRAWN BF	DATE 7/12/83	PART NAME SPRING SHANK ROLLING PLOW	
CHECKED BF	DATE 4/24/84	SCALE 1 1/2" = 1"	MATERIAL
APPROVED BF	DATE 7/13/83	SIZE C	DRAWING NO. 41430 1/1
TOLERANCES UNLESS NOTED			
DECIMAL (0.00) ± 0.03 IN. 0.076 MM			
(0.000) ± 0.010 IN. 0.254 MM			
ANGLES ± 1°			
FRACTIONS ± 1/32 IN. 0.794 MM			

ECO	REF.	CHANGE	DESCRIPTION	BY	DATE
	E1	ADD NOTE 3		DAL	1185
	D	WR RELEASE 058506		ADM	4-85
	C	±1/16 to ±3/16		BF	6/11/84
	B	11 1/2 to 11 3/4, 3/4 to 1"		BF	4/24/84
	A	ADDED NOTE		BF	7/13/83
		REPLACED 40607		BF	7/13/83
	O	RELEASED			

This document contains proprietary information belonging to Lear Siegler, Inc. and such information may not be disclosed to others, reproduced, copied or used without written authority from an officer of Lear Siegler Inc.

Z
Y
X
W
V
U
T
S
R
Q
P
O
N
M
L
K
J
I
H
G
F
E
D
C
B
A

BRUNING 40-21 45189