



# EP HEAVY DUTY AUGER SERIES PRICE LIST

**3-Year Warranty**  
**Lifetime covering output pullout**

An exceptional price with heavy-duty performance, units range from 6 - 30 GPM and up to 3000 PSI. Mountings are available for front-end loader, skid-steer, excavator, mini-excavator, and backhoe.

## TO PRICE A COMPLETE UNIT

Drive Units (pg. 2)	_____
Hoses & Couplers (pg. 2)	_____
Mounts (pgs. 3-4)	_____
Augers (pgs. 5-10)	_____
Auger Accessories (pgs. 11-12)	_____
Repair Parts (pgs. 12-13)	_____
Freight	_____
<b>TOTAL</b>	_____

500 E. 3rd St.      Tel: (573) 642.2246  
P.O. Box 368      Fax: (573) 642.2240  
Fulton, MO 65251      Email: sales@danuser.com

[www.danuser.com](http://www.danuser.com)

<b>MODEL EP6</b>		<b>\$1,355.00</b>		<b>MODEL EP10</b>		<b>\$1,455.00</b>	
2" Hex Part No.		10180		2" Hex Part No.		10181	
2-9/16" Rd Part No.		20180		2-9/16" Rd Part No.		20181	
Approx. Ship Weight (lbs.)		138		Approx. Ship Weight (lbs.)		139	
Maximum Auger Diameter		24"		Maximum Auger Diameter		30"	
Hydraulic Flow		6 - 15 GPM		Hydraulic Flow		10 - 20 GPM	
Maximum Hydraulic Pressure		3000 PSI		Maximum Hydraulic Pressure		3000 PSI	
Maximum Hydraulic Back Pressure		1500 PSI		Maximum Hydraulic Back Pressure		1500 PSI	
Gearbox Ratio		3.86:1		Gearbox Ratio		3.86:1	
Speed		Torque		Speed		Torque	
<b>GPM</b>	<b>RPM</b>	<b>PSI</b>	<b>Ft.-lbs.</b>	<b>GPM</b>	<b>RPM</b>	<b>PSI</b>	<b>Ft.-lbs.</b>
6	36	2000	1014	10	48	2000	1270
8	48	2500	1267	12	58	2500	1587
10	60	3000	1520	14	68	3000	1904
12	73			16	77		
14	85			18	87		
15	91			20	97		

<b>MODEL EP15</b>		<b>\$1,525.00</b>		<b>MODEL EP20</b>		<b>\$1,645.00</b>	
2" Hex Part No.		10182		2" Hex Part No.		20001	
2-9/16" Rd Part No.		20182		2-9/16" Rd Part No.		20184	
Approx. Ship Weight (lbs.)		140		Approx. Ship Weight (lbs.)		140	
Maximum Auger Diameter		36"		Maximum Auger Diameter		36"	
Hydraulic Flow		15 - 30 GPM		Hydraulic Flow		20 - 35 GPM	
Maximum Hydraulic Pressure		3000 PSI		Maximum Hydraulic Pressure		3000 PSI	
Maximum Hydraulic Back Pressure		1500 PSI		Maximum Hydraulic Back Pressure		1500 PSI	
Gearbox Ratio		3.86:1		Gearbox Ratio		3.86:1	
Speed		Torque		Speed		Torque	
<b>GPM</b>	<b>RPM</b>	<b>PSI</b>	<b>Ft.-lbs.</b>	<b>GPM</b>	<b>RPM</b>	<b>PSI</b>	<b>Ft.-lbs.</b>
15	49	2000	1874	20	50	2000	2465
18	59	2500	2342	22	55	2500	3081
20	65	3000	2811	26	65	3000	3697
24	78			30	75		
28	92			32	80		
30	98			35	87		

PN	DESCRIPTION	WT.	PRICE
10047	Cross Port Relief Valve (required for pressures exceeding 3000 PSI)	7	\$345.00
PN	DESCRIPTION	WT.	PRICE
10050	1/2" HOSE KIT with flat face ISO couplers	14	\$213.00
10051	3/4" HOSE KIT with flat face ISO couplers	19	\$295.00
10043	1/2" HOSE KIT (includes fittings NOT couplers)	10	\$140.00
10044	3/4" HOSE KIT (includes fittings NOT couplers)	14	\$222.00
21350	Front-end loader 3/4" HOSE KIT, 25' long with flat face ISO couplers and pioneer couplers. Mounting bracket included for bolting or welding. Hardware not included.	35	\$395.00

**Hoses are 96" long with abrasion sleeves**

**3/4" hoses REQUIRED for 20 GPM or more**

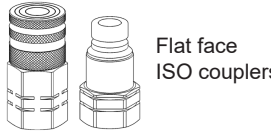

### SKID-STEER QUICK ATTACH

Mounting Kit (includes knuckle and cradle) attaches the drive unit to skid-steers with standard 2-pin system and SAE quick couplers.

PN	WT.	PRICE
10488	128	\$395.00
*10488CSE	128	\$420.00

\* Fits Case Models 1835B, 1835C, & 1840

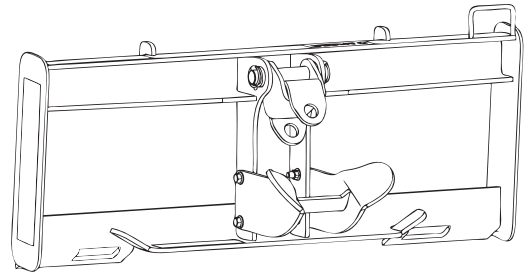

### OFFSET FRONT-END LOADER QUICK ATTACH

Mounting Kit (includes knuckle and cradle) attaches the drive unit to front-end loader quick attach systems. Choose the correct quick attach below.

PN	DESCRIPTION	WT.	PRICE
20652	Skid-Steer Quick Attach Plate Offset w/ hardware	72	\$345.00
20653	Euro/Global Offset w/ hardware	86	\$370.00
20659	John Deere 200-500 Offset w/ hardware	166	\$595.00

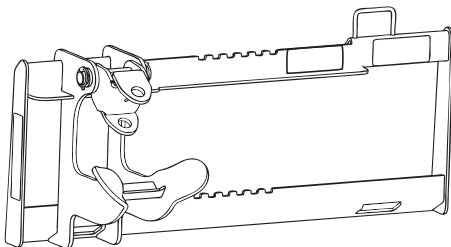

PN 20652

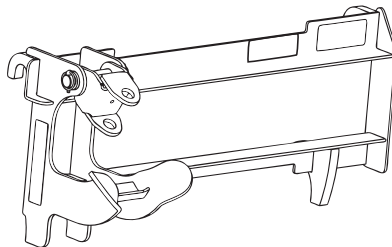

PN 20653

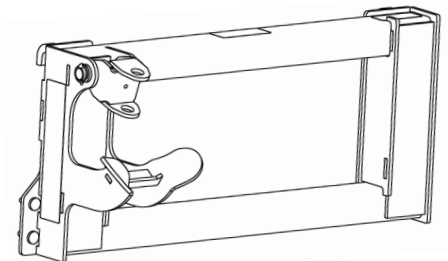

PN 20659

### BOLT-ON BUCKET

Mounting Kit (includes knuckle) attaches the drive unit to a flat vertical surface. Kit does not include bucket mounting hardware.

PN	WT.	PRICE
10489	43	\$260.00

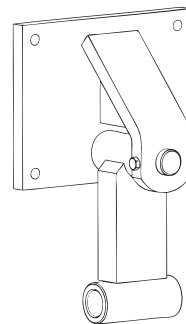

If you do not see your make or model listed, contact Danuser.

**CALL FOR PRICE ON CUSTOM MOUNTS**

**QUICK-ATTACH MOUNTING KITS**

PN	MAKES & MODELS	WT.	PRICE
10172	Cat 420D & 420E (pin grabber)	75	\$668.00
172000	Cat 305.5E Mini-Ex	55	\$562.00
*172010	Cat 2008-2013 302D, 302.4D, 302.5, 302.5C, 302.7D Mini-Ex	45	\$416.00
10173	JCB 208S, 803, & 8018	40	\$555.00
10174	JD 790ELC	172	\$1,036.00
10175	JD 135C RTS	82	\$639.00
20200	JD 27/35D Mini-Ex (wedge)	61	\$416.00
20201	JD 50D/50G Mini-Ex (wedge)	80	\$416.00
20042	KOMATSU PC50MR-2	50	\$416.00
20210	YANMAR VIO40/45/50/55 (quick coupler)	50	\$562.00
10176	YANMAR VIO20 (quick coupler)	45	\$552.00
10177	YANMAR VIO27/35 (quick coupler)	50	\$562.00
*20007	KUBOTA KX161-3 & U45	75	\$416.00
*20008	KUBOTA C39/45, KX040-3/71-3/91-3/121-3, & U35	75	\$416.00
*20026	KUBOTA KX057 & U55	75	\$416.00
*20037	KUBOTA U25	75	\$416.00
*20075	KUBOTA KX141-3 & U15	75	\$416.00
20202	BOBCAT X-Change	55	\$465.00
20258	TAG QC27 Style Quick Coupler	43	\$740.00
172918	TAG Pin Grabber Style Quick Coupler	61	\$562.00

\* USA models only.

**TLB (BACKHOE) & EXCAVATOR**

Less dipperstick pin.  
 For dipperstick widths up to 13".  
 Bucket pin diameters listed below.

PN	BUCKET PIN DIA.	WT.	PRICE
10296	1-5/8 inch	49	\$388.00
10231	1-3/4 inch	49	\$388.00
10481	45 mm	51	\$388.00
10232	50 mm	51	\$388.00
10233	55 mm	48	\$388.00
Welded mount w/ fixed width		50	\$490.00

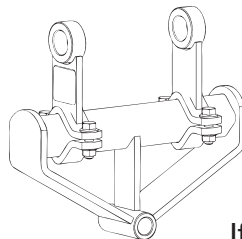

**SMALL BACKHOE & MINI-EXCAVATOR**

Less dipperstick pin.  
 For dipperstick widths from 3-1/2" to 8".  
 Bucket pin diameters listed below.

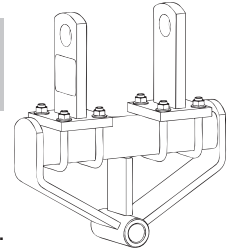

PN	BUCKET PIN DIA.	WT.	PRICE
10201	25 mm	42	\$257.00
10201	1 inch	42	\$257.00
10202	30 mm	42	\$257.00
10203	1-1/4 inch	42	\$257.00
10204	35 mm	42	\$257.00
10204	1-3/8 inch	42	\$257.00
10205	1-1/2 inch	42	\$257.00
10206	40 mm	42	\$257.00
10298	1-5/8 inch	42	\$257.00
10207	1-3/4 inch	46	\$257.00
10208	45 mm	46	\$257.00
10209	50 mm	46	\$257.00
10210	2 inch	46	\$257.00

**UNIVERSAL MOUNTING KIT**

Mounting Kit (includes plate, knuckle, and cradle) requires fabrication and welding for installation to machine. Weldable dimensions are 10" wide and 16" long. Hardware included.

PN	WT.	PRICE
21354	60	\$290.00

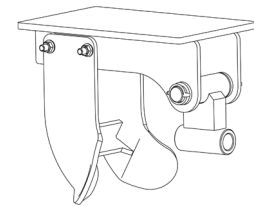

If you do not see your make or model listed, contact Danuser.

**CALL FOR PRICE ON CUSTOM MOUNTS**

**WOBBLE AUGERS**

**4' Length**

DIA.	PRICE	WT.	2" HEX PN	2-9/16" RD PN	2" RD PN
4"	\$299.00	58	20600	20601	20602
6"	\$378.00	86	20603	20604	20605
9"	\$577.00	122	20606	20607	20608

To be used with Danuser PRO and EP units.

- Spiral & Checkered Hardfacing
- Hardened Fishtail Point

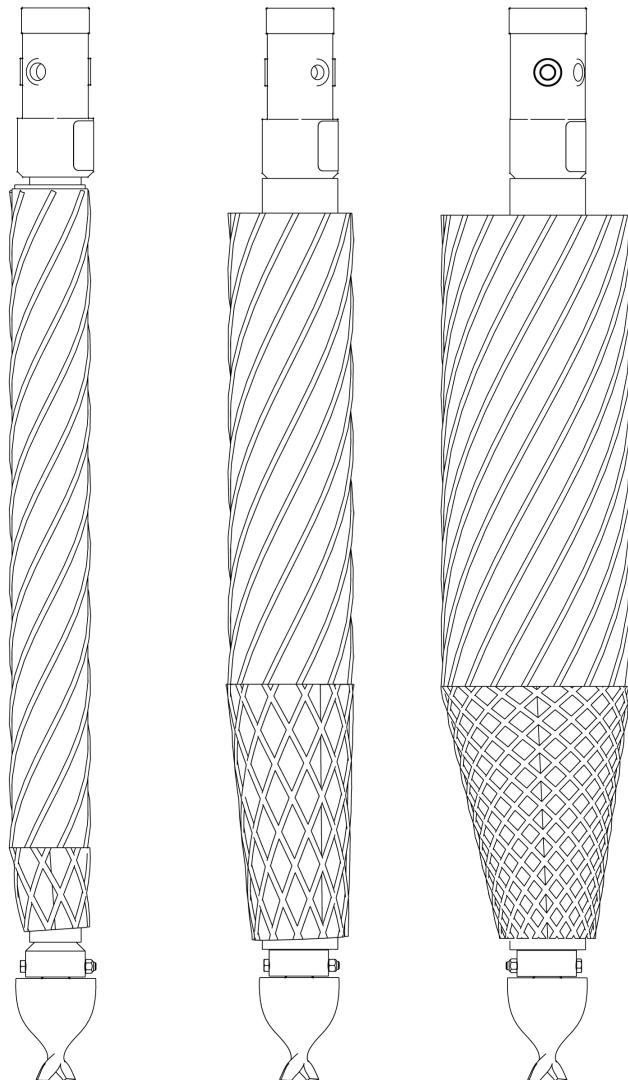

**NOTE:** The 9" Wobble Auger should be used on a machine with an Operating Load or Rated Operating Capacity of 2250 lbs. or greater, utilizing an auger drive with 2000 ft.-lbs. of torque or greater.

**Danuser's Dirtless Digging Solution**

- Pushes through
  - Dirt
  - Sand
  - Clay
  - Asphalt
  - Compacted Rock
  - Embedded Rock
- No loose dirt in the bottom of the hole
- No excess dirt to fall back into the hole
- No dirt to remove around the top of the hole
- Compacted hole ready for concrete
- Suggested mounting to skid-steers, front-end loaders, backhoes, excavators, mini-excavators, telescopic handlers, articulated loaders, and integrated tool carriers
- Requires down force for correct operation
- Not for 3-point hitch mounted diggers

See patent at [danuser.com/patents](http://danuser.com/patents)

**POINTS**

PN	DESCRIPTION	PRICE
10331	Dirt	\$28.00
10332	Hardfaced	\$61.00
10335	Carbide	\$148.00

**FABRICATED AUGERS**

**Light to Moderate Ground Conditions**

- Fabricated Boring Head
- Hardened Bolt-on Teeth - Std. Incl.  
     Gage Teeth in Outside Positions  
     Wisdom Teeth in Inside Positions
- Hardened Fishtail Point
- 5/16" Heavy-Duty Double Flighting

**4' Length Augers- STANDARD**

DIA.	PRICE	NO. OF TEETH	WT.	2" HEX PN	2-9/16" RD PN	2" RD PN
4"	\$221.00	0	42	10600	10601	10602
6"	\$236.00	2	46	10603	10604	10605
8"	\$340.00	2	78	10606	10607	10608
9"	\$352.00	3	85	10609	10610	10611
10"	\$389.00	3	98	10612	10613	10614
12"	\$402.00	4	115	10615	10616	10617
15"	\$556.00	5	135	10618	10619	10620
16"	\$575.00	5	146	10621	10622	10623
18"	\$649.00	6	170	10624	10625	10626
20"	\$803.00	6	182	10627	10628	10629
24"	\$834.00	8	211	10630	10631	10632
30"	\$1,069.00	9	272	10633	10634	10635
36"	\$1,359.00	11	365	10636	10637	10638

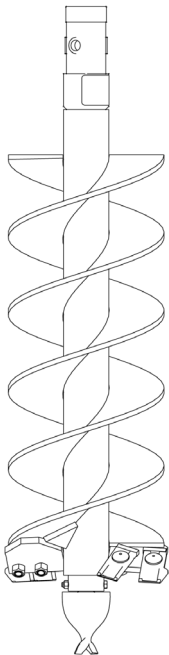

**3' Length Augers**

DIA.	PRICE	NO. OF TEETH	WT.	2" HEX PN	2-9/16" RD PN	2" RD PN
4"	\$216.00	0	42	10600-3	10601-3	10602-3
6"	\$227.00	2	42	10603-3	10604-3	10605-3
8"	\$319.00	2	57	10606-3	10607-3	10608-3
9"	\$330.00	3	62	10609-3	10610-3	10611-3
10"	\$350.00	3	69	10612-3	10613-3	10614-3
12"	\$366.00	4	78	10615-3	10616-3	10617-3
15"	\$484.00	5	87	10618-3	10619-3	10620-3
16"	\$515.00	5	93	10621-3	10622-3	10623-3
18"	\$541.00	6	106	10624-3	10625-3	10626-3
20"	\$628.00	6	134	10627-3	10628-3	10629-3
24"	\$742.00	8	153	10630-3	10631-3	10632-3
30"	\$948.00	9	208	10633-3	10634-3	10635-3
36"	\$1,184.00	11	275	10636-3	10637-3	10638-3

**FABRICATED AUGERS**

**Light to Moderate Ground Conditions**

- Fabricated Boring Head
- Hardened Bolt-on Teeth - Std. Incl.  
     Gage Teeth in Outside Positions  
     Wisdom Teeth in Inside Positions
- Hardened Fishtail Point
- 5/16" Heavy-Duty Double Flighting

**5' Length Augers**

DIA.	PRICE	NO. OF TEETH	WT.	2" HEX PN	2-9/16" RD PN	2" RD PN
4"	\$268.00	0	51	10600-5	10601-5	10602-5
6"	\$319.00	2	51	10603-5	10604-5	10605-5
8"	\$427.00	2	101	10606-5	10607-5	10608-5
9"	\$433.00	3	111	10609-5	10610-5	10611-5
10"	\$494.00	3	126	10612-5	10613-5	10614-5
12"	\$500.00	4	145	10615-5	10616-5	10617-5
15"	\$680.00	5	164	10618-5	10619-5	10620-5
16"	\$778.00	5	177	10621-5	10622-5	10623-5
18"	\$850.00	6	207	10624-5	10625-5	10626-5
20"	\$937.00	6	254	10627-5	10628-5	10629-5
24"	\$1,004.00	8	268	10630-5	10631-5	10632-5
30"	\$1,519.00	9	445	10633-5	10634-5	10635-5
36"	\$1,663.00	11	501	10636-5	10637-5	10638-5

**6' Length Augers**

DIA.	PRICE	NO. OF TEETH	WT.	2" HEX PN	2-9/16" RD PN	2" RD PN
4"	\$299.00	0	60	10600-6	10601-6	10602-6
6"	\$412.00	2	60	10603-6	10604-6	10605-6
8"	\$500.00	2	128	10606-6	10607-6	10608-6
9"	\$515.00	3	141	10609-6	10610-6	10611-6
10"	\$577.00	3	160	10612-6	10613-6	10614-6
12"	\$628.00	4	186	10615-6	10616-6	10617-6
15"	\$829.00	5	193	10618-6	10619-6	10620-6
16"	\$942.00	5	208	10621-6	10622-6	10623-6
18"	\$1,020.00	6	244	10624-6	10625-6	10626-6
20"	\$1,169.00	6	296	10627-6	10628-6	10629-6
24"	\$1,354.00	8	325	10630-6	10631-6	10632-6
30"	\$1,911.00	9	527	10633-6	10634-6	10635-6
36"	\$2,158.00	11	615	10636-6	10637-6	10638-6

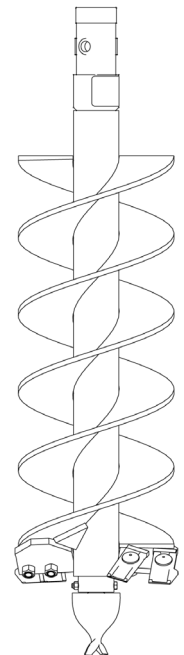



**CAST HEAD AUGERS**

**Difficult Ground Conditions**

- Cast Steel Boring Head
- Hardened Drive-in Teeth - Std. Incl.  
     Gage Teeth in Outside Positions  
     Chisel Teeth in Inside Positions
- Hardened Fishtail Point
- 5/16" Heavy-Duty Double Flighting

**4' Length Augers- STANDARD**

DIA.	PRICE	NO. OF TEETH	WT.	2" HEX PN	2-9/16" RD PN	2" RD PN
6"	\$358.00	2	48	10657	10658	10659
8"	\$514.00	4	83	10660	10661	10662
9"	\$556.00	4	89	10663	10664	10665
10"	\$575.00	4	102	10666	10667	10668
12"	\$593.00	4	117	10669	10670	10671
15"	\$747.00	6	139	10672	10673	10674
16"	\$801.00	6	148	10675	10676	10677
18"	\$880.00	6	168	10678	10679	10680
20"	\$1,226.00	6	231	10681	10682	10683
24"	\$1,226.00	8	210	10684	10685	10686
30"	\$1,614.00	10	280	10687	10688	10689
36"	\$1,832.00	12	376	10690	10691	10692

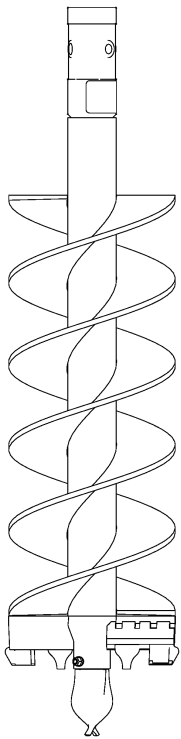

**3' Length Augers**

DIA.	PRICE	NO. OF TEETH	WT.	2" HEX PN	2-9/16" RD PN	2" RD PN
6"	\$345.00	2	40	10657-3	10658-3	10659-3
8"	\$469.00	4	67	10660-3	10661-3	10662-3
9"	\$500.00	4	70	10663-3	10664-3	10665-3
10"	\$505.00	4	74	10666-3	10667-3	10668-3
12"	\$530.00	4	81	10669-3	10670-3	10671-3
15"	\$670.00	6	90	10672-3	10673-3	10674-3
16"	\$706.00	6	96	10675-3	10676-3	10677-3
18"	\$793.00	6	108	10678-3	10679-3	10680-3
20"	\$1,066.00	6	122	10681-3	10682-3	10683-3
24"	\$1,080.00	8	154	10684-3	10685-3	10686-3
30"	\$1,411.00	10	209	10687-3	10688-3	10689-3
36"	\$1,495.00	12	276	10690-3	10691-3	10692-3



**CAST HEAD AUGERS**

**Difficult Ground Conditions**

- Cast Steel Boring Head
- Hardened Drive-in Teeth - Std. Incl.  
     Gage Teeth in Outside Positions  
     Chisel Teeth in Inside Positions
- Hardened Fishtail Point
- 5/16" Heavy-Duty Double Flighting

**5' Length Augers**

DIA.	PRICE	NO. OF TEETH	WT.	2" HEX PN	2-9/16" RD PN	2" RD PN
6"	\$448.00	2	62	10657-5	10658-5	10659-5
8"	\$577.00	4	121	10660-5	10661-5	10662-5
9"	\$608.00	4	125	10663-5	10664-5	10665-5
10"	\$690.00	4	143	10666-5	10667-5	10668-5
12"	\$706.00	4	158	10669-5	10670-5	10671-5
15"	\$814.00	6	167	10672-5	10673-5	10674-5
16"	\$834.00	6	180	10675-5	10676-5	10677-5
18"	\$927.00	6	209	10678-5	10679-5	10680-5
20"	\$1,272.00	6	241	10681-5	10682-5	10683-5
24"	\$1,365.00	8	269	10684-5	10685-5	10686-5
30"	\$1,772.00	10	374	10687-5	10688-5	10689-5
36"	\$1,915.00	12	502	10690-5	10691-5	10692-5

**6' Length Augers**

DIA.	PRICE	NO. OF TEETH	WT.	2" HEX PN	2-9/16" RD PN	2" RD PN
6"	\$489.00	2	70	10657-6	10658-6	10659-6
8"	\$644.00	4	138	10660-6	10661-6	10662-6
9"	\$675.00	4	140	10663-6	10664-6	10665-6
10"	\$721.00	4	146	10666-6	10667-6	10668-6
12"	\$736.00	4	189	10669-6	10670-6	10671-6
15"	\$896.00	6	196	10672-6	10673-6	10674-6
16"	\$1,056.00	6	212	10675-6	10676-6	10677-6
18"	\$1,071.00	6	246	10678-6	10679-6	10680-6
20"	\$1,416.00	6	284	10681-6	10682-6	10683-6
24"	\$1,530.00	8	327	10684-6	10685-6	10686-6
30"	\$2,081.00	10	529	10687-6	10688-6	10689-6
36"	\$2,235.00	12	616	10690-6	10691-6	10692-6

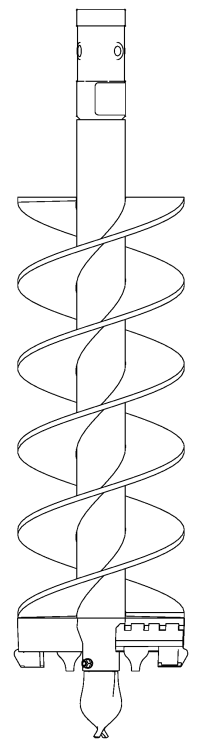

### BULLET ROCK AUGERS

Rock, Concrete, Asphalt, and Frozen Ground  
4' Length Augers

DIA.	PRICE	NO. OF TEETH	WT.	2" HEX PN	2-9/16" RD PN	2" RD PN
4.5"	\$810.00	4	73	10700	10701	10702
6"	\$1,212.00	6	66	10703	10704	10705
7"	\$1,249.00	8	80	10706	10707	10708
8"	\$1,372.00	8	94	10709	10710	10711
9"	\$1,392.00	8	103	10712	10713	10714
10"	\$1,429.00	10	113	10715	10716	10717
12"	\$1,566.00	12	135	10718	10719	10720
15"	\$1,800.00	15	171	10740	10741	10742
18"	\$1,973.00	18	208	10727	10728	10729
24"	\$2,351.00	22	291	10730	10731	10732
30"	\$2,599.00	24	340	10733	10734	10735
36"	\$2,945.00	30	395	10736	10737	10738

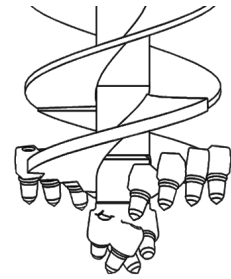

Bullet Rock Pilot  
PN 10758  
List Price: \$370.00

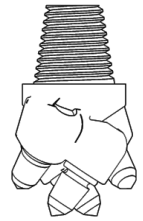

Bullet Rock Tooth  
PN 10759  
List Price: \$14.50



### BULLET ROCK AUGER TOOLS

PN	DESCRIPTION	PRICE
10764	Bullet Tooth Puller	\$70.00
10765	Bullet Tooth Hammer	\$43.00
10766	Bullet Tooth Hammer & Puller	\$107.00

### 2" ROCK DRILL

#### Pilot Holes

- For pilot holes or setting posts up to 2" O.D. in solid rock

### 3' Length Augers

DIA.	PRICE	WT.	2" HEX PN	2-9/16" RD PN	2" RD PN
2"	\$335.00	30	10739	10743	10744

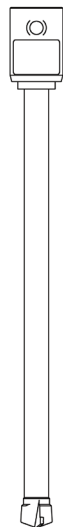

### TREE AUGERS

#### Tree and Shrub Planting

- Fabricated Boring Head
- Hardened Bolt-on Teeth - Std. Incl. Gage Teeth in Outside Positions Wisdom Teeth in Inside Positions
- Hardened Fishtail Point
- 5/16" Heavy-Duty Double Flighting

### 4' Length Augers

DIA.	PRICE	NO. OF TEETH	WT.	2" HEX PN	2-9/16" RD PN	2" RD PN
18"-9"	\$607.00	7	130	10639	10640	10641
24"-12"	\$804.00	10	186	10642	10643	10644
30"-15"	\$1,001.00	11	228	10645	10646	10647
36"-18"	\$1,203.00	13	304	10648	10649	10650

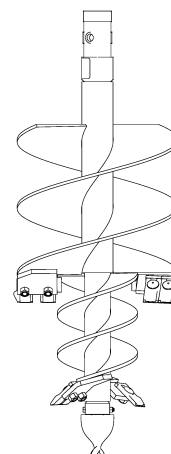

## AUGER POINTS AND TEETH

	Fishtail Point		4" Auger Point		Gage Tooth		Wisdom Tooth		Chisel Tooth	
Dirt	PN 10331	\$28.00	PN 10333	\$52.00	PN 10340	\$3.75	PN 10337	\$3.75	PN 10342	\$3.75
Hardfaced	PN 10332	\$61.00	PN 10334	\$90.00	PN 10341	\$7.95	PN 10338	\$7.95	PN 10343	\$8.75
Carbide	PN 10335	\$148.00	PN 10336	\$167.00			PN 10339	\$21.75	PN 10344	\$16.25

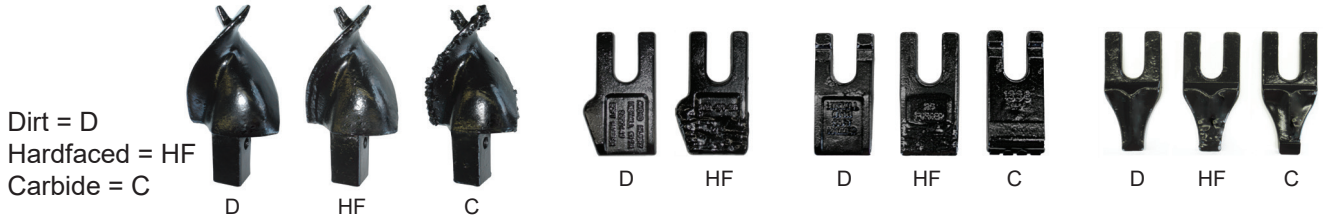

## VARIABLE LENGTH EXTENSIONS

Variable length auger extensions store inside the column of 10" diameter or larger augers. Extension increments are every 6" on 12" - 24" auger extensions and every 12" on 48" - 72" auger extensions.

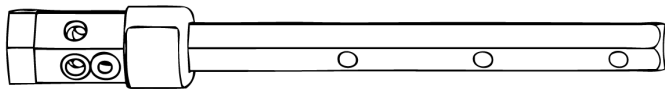

**2" Hex**

LENGTH	PRICE	WT.	PN
24"	\$211.00	32	10900
48"	\$290.00	56	10901
72"	\$378.00	84	10902

**2-9/16" Round**

LENGTH	PRICE	WT.	PN
12"	\$154.00	22	10903
24"	\$216.00	38	10904
48"	\$299.00	73	10905
72"	\$397.00	84	10906

**2" Round**

LENGTH	PRICE	WT.	PN
24"	\$154.00	24	10907
48"	\$216.00	46	10908
72"	\$298.00	66	10909

## FIXED LENGTH EXTENSIONS

Fixed length auger extensions extend the auger's digging depth by the length of the extension.

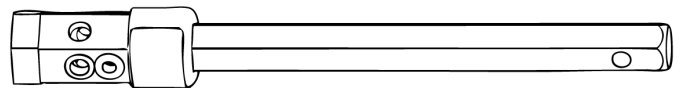

**2" Hex**

LENGTH	PRICE	WT.	PN
12"	\$152.00	20	10910
24"	\$185.00	32	10911
48"	\$260.00	56	10912
72"	\$341.00	84	10913

**2-9/16" Round**

LENGTH	PRICE	WT.	PN
12"	\$152.00	38	10914
24"	\$185.00	40	10915
48"	\$260.00	76	10916
72"	\$359.00	110	10917

**2" Round**

LENGTH	PRICE	WT.	PN
24"	\$143.00	25	10918
48"	\$199.00	47	10919
72"	\$273.00	68	10920

**ADAPTERS**

Connect Danuser drive units to other augers or Danuser augers to other drive units.

DRIVE UNIT	AUGER COLLAR	PRICE	WT.	PN	DRIVE UNIT	AUGER COLLAR	PRICE	WT.	PN
2" Hex	2-9/16" Rd.	\$216.00	18	10921	2" Rd.	2-9/16" Rd.	\$131.00	11	10926
2" Hex	2" Rd.	\$199.00	18	10922	2" Hex	2-9/16" Rd.	\$148.00	18	*20211
2-9/16" Rd.	2" Hex	\$131.00	14	10923	2-9/16" Rd.	2-9/16" Rd.	\$148.00	15	*20212
2-9/16" Rd.	2" Rd.	\$138.00	12	10924	2" Hex	2" Rd.	\$148.00	18	*20214
2" Rd.	2" Hex	\$118.00	12	10925	2-9/16" Rd.	2" Rd.	\$148.00	12	*20215

\* Allows attachment of augers with 1/2" diameter bolt.

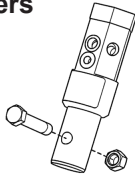

**REPAIR PARTS**

PN	DESCRIPTION	PRICE	PN	DESCRIPTION	PRICE
1600	Klik Pin <b>NET PRICE</b>	\$0.55	10247	Knuckle Sub-Assembly	\$156.00
2805	Self-locking Nut (3/8"-16)	\$0.46	10328	Auger Collar - 2" Hex	\$63.00
3041	Bolt (3/8"-16 x 3-1/2", Gr. 8)	\$1.21	10329	Auger Collar - 2-9/16" Rd.	\$52.00
3092	Nut (5/8"-11)	\$1.55	10330	Auger Collar - 2" Rd.	\$39.00
6196	Nut (1/2"-13)	\$0.79	10410	Carriage Bolt for Teeth	\$1.33
9591B	Bucket Mount Assembly	\$165.76	10411	Nut for Teeth	\$0.54
9595	Pin (1-1/4" x 6")	\$17.65	10412	Nut for Point	\$0.26
9598	Pin (1-1/4" x 7-1/8")	\$20.45	10413	Bolt for Point (6" + Dia. Augers)	\$0.53
10038	Special Retaining Bolt (Hex)	\$8.35	10416	Bolt for Point (4" Dia. Augers)	\$0.23
10039	Special Retaining Bolt (Rd.)	\$10.22	10482	Socket Head Bolt (M12 x 1.75 x 35mm)	\$1.04
10041	Nut (3/4"-10) - 2" Hex	\$0.73	10745	2" Rock Drill Pilot Bit	\$105.00
10042	Nut (7/8"-9) - 2-9/16" Rd.	\$1.25	10760	Bullet Tooth Holder	\$28.00
10048	Male Hydraulic Coupler	\$36.00	10964	EP20 Hydraulic Motor	*CALL
10049	Female Hydraulic Coupler	\$58.00	10965	Cradle Assembly	\$62.00
10183	Planetary Gear Reduction (Hex)	*CALL	10975	Bolt (1/2"-13 x 1-3/4", Gr. 8)	\$0.99
10184	EP6 Hydraulic Motor	*CALL	10976	Knuckle Assembly	\$101.00
10185	EP10 Hydraulic Motor	*CALL	10979	O-ring	\$2.85
10186	EP15 Hydraulic Motor	*CALL	10980	Output Seal	\$39.00
10193	Pin (1-1/4" x 9-1/2")	\$19.80	10996	Output Spindle 2" Hex	\$321.30
10196	Socket Head Bolt (7/16"-14 x 2")	\$0.99	10997	Output Spindle 2-9/16" Rd.	\$321.30
10197	Nut (7/16"-14)	\$0.63	20012	Lock Pin	\$1.80
10198	Knuckle Assembly	\$63.00	20034	#10 O-ring #8 JIC Elbow	\$6.81
10219	Knuckly Sub-Assembly	\$135.00	20183	Planetary Gear Reduction (Rd)	*CALL
10220	U-Bolt (1/2"-13 x 3-3/4")	\$4.75	20186	Housing Assembly	*CALL
10242	Tube-Clamp	\$21.00	20190	Hose Assembly	\$19.92
10243	Bolt (5/8"-11 x 2", Gr. 5)	\$4.37	20191	Nut (7/8"-14)	\$1.55

\* Provide model number and serial number.

**REPAIR PARTS FOR OLDER SERIAL NUMBERS**

The EP's below used the 1 piece hose assembly with 90° elbow built in.

PN	MODEL	SERIAL NUMBER
10180	EP6	1001-1306
10181	EP10	1001-2061
10182	EP15	1001-1823

PN	DESCRIPTION	PRICE
10483	Hose Assembly SUB (see below)	10999

The EP's below used the 2 piece hose assembly (PN 20033 hose and PN 20034 90° elbow which makes the kit PN 10999) and PN 10192 Housing without the trapped hoses.

PN	MODEL	SERIAL NUMBER
10180	EP6	1307-1728
10181	EP10	2062-3143
10182	EP15	1824-3297
20001	EP20	1001-1159

PN	MODEL	SERIAL NUMBER
20180	EP6R	0-22
20181	EP10R	0-68
20182	EP15R	0-83
20184	EP20R	1001-1013

PN	DESCRIPTION	PRICE
10999	Motor Hose Kit (20033 hose + 20034 elbow)	\$24.00
20033	Hose Assembly (less elbow)	\$17.19
20034	#10 O-ring #8 JIC Elbow (less hose)	\$6.81
10192	Housing Assembly SUB the following below:	
20186	Housing Assembly (Qty. 1)	*CALL
20190	Hose Assembly (Qty. 2)	\$19.92
20191	Nut (7/8"-14) (Qty. 2)	\$1.55

\* Provide model number and serial number.

**SAFETY SIGNS**

PN	DESCRIPTION	PRICE
DIG2	Safety Sign	N/C
DIG3	Safety Sign	N/C
DIG4	Safety Sign	N/C
DIG5	Safety Sign	N/C
DIG6	Safety Sign	N/C
DIG7	Safety Sign	N/C

PN	DESCRIPTION	PRICE
DIG8	Safety Sign	N/C
DIG27	Safety Sign	N/C
DIG35	Safety Sign	N/C
DIG41	Safety Sign	N/C
20673	811 Decal	N/C

F.O.B. FULTON, MISSOURI  
 Dollars are U.S. Dollars.

Danuser reserves the right to make changes in design, specifications, and prices without notice and without incurring any obligation relating to such changes.