

OPERATION

In most cases centrifugal pumps are high volume, low pressure pumps. The pump works the hardest at the lowest pressure because it is producing its maximum liquid volume, consequently it has a light load at maximum pressure because it is producing the minimum in volume.

The discharge line from a centrifugal pump can be completely shut off while the pump is running without harming the pump. The solution will just recirculate within the pump volute. It should be noted, however, that prolonged circulation produces heat to the solution and high temperatures can cause damage to the pump.

Centrifugal pumps are generally not self-priming, therefore, one of two things must be accomplished before starting the pump. Either be sure that the liquid in the supply tank is higher than the pump, so the pump volute will be flooded, or prime the pump before starting. Once the pump has been primed, it will lift the solution as much as it is capable.

Air in the line will prevent the pump from building pressure. The air must be worked out of the line by the flow before the pump will obtain any pressure.

Never run the pump dry for more than 30 seconds as the bearings need the solution for lubrication. The bearings can

be damaged by the heat produced when they are not lubricated.

In these pumping systems the pressure is regulated by means of a nylon ball valve.

The nylon ball valve acts as a throttling valve. When this valve is open, maximum pressure is available to the tips. Closing the valve will decrease the pressure.

The tee valve is the "off-on" control which allows the operator to control (off-on) each of the separate sections of the boom.

A jet agitation kit is optional and not included with this pump kit. It can be added very easily if needed to keep the chemical solution in suspension.

AFTER SPRAYING

After spraying, rinse and clean the equipment both inside and out. Flush the entire pumping system with water and a neutralizing agent such as Nutra-Sol or equivalent.

WINTER STORAGE

The sprayer should be winterized before storage by pumping a 50-50 solution of water and ant-freeze through the entire plumbing. Proper care and maintenance will prolong the life of your sprayer.

REPAIR PARTS LIST

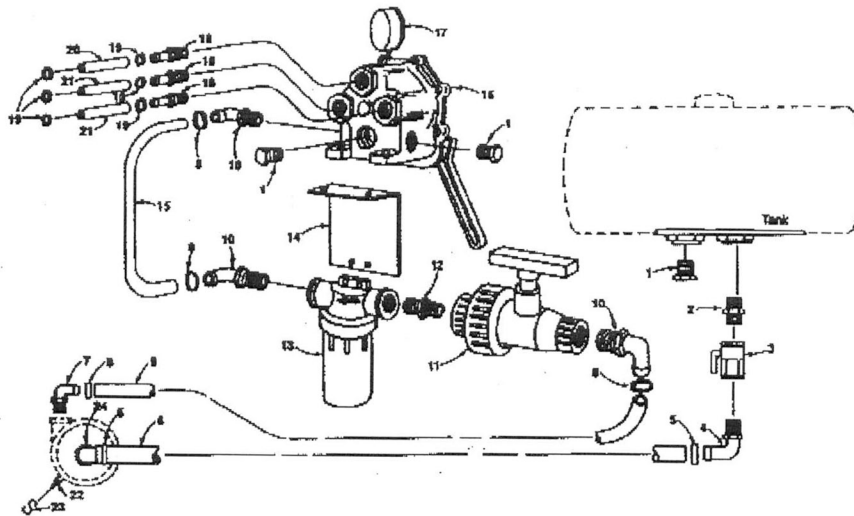

Ref.	Part No.	Description	Quantity			
			718-M-34	718-M-12	716-M-34	716-M-12
1	5102025	Nylon Plug, 3/4"	2	3	3	3
2	5011103	Nylon Close Nipple, 1-1/4"	1	1	1	1
3	5143078	Ball Valve, 1-1/4"	1	1	1	1
4	5010100	Nylon Elb, 1-1/4" MNPT x 1-1/4"	1	1	1	1
5	6061026	Hose Clamp, 1-1/4" (5224)	2	2	2	2
6	5020110	Hose, 1-1/4"-2 Brd. x 6 Ft.	1	1	1	1
7	5010032	Nylon Elb, 1" MNPT x 3/4"	1	1	1	1
8	5061024	Hose Clamp, 3/4" (5212)	4	4	4	4
9	5020174	Hose, 3/4"-1 Brd. x 8 Ft.	1	1	1	1
10	5010028	Nylon Elb, 3/4" MNPT x 3/4"	3	3	3	3
11	5143206	Ball Valve, 3/4"	1	1	1	1
12	5011055	Nylon Close Nipple, 3/4"	1	1	1	1
13	5116179	Nylon Strainer, 3/4"	1	1	1	1
14	5036394	Strainer Support Bracket	1	1	1	1
15	6020247	Hose, 3/4"-1 Brd. x 18"	1	1	1	1
16	6271949	Tee Valve, (17-1)	1	1	1	1
17	5187007	Gauge, 100#	1	1	1	1
18	5067017	Nylon Hose Barb, 1/2" x 1/2"	-	3	-	3
18	5067019	Nylon Hose Barb, 1/2" x 3/4"	3	-	3	-
19	5061022	Hose Clamp, 1/2" (5208)	-	6	-	6

Ref.	Part No.	Description	Quantity			
			718-M-34	718-M-12	716-M-34	716-M-12
19	5061024	Hose Clamp, 3/4" (5212)	6	-	6	-
20	5020197	Hose, 1/2"-1 Brd. x 13 Ft.	-	-	-	1
20	5020202	Hose, 3/4"-1 Brd. x 15 Ft.	-	-	1	-
20	5020279	Hose, 1/2"-1 Brd. x 15 Ft.	-	1	-	-
20	5020281	Hose, 3/4"-1 Brd. x 15 Ft.	1	-	-	-
21	5020279	Hose, 1/2"-1 Brd. x 15 Ft.	-	-	-	2
21	5020281	Hose, 3/4"-1 Brd. x 15 Ft.	-	-	2	-
21	5020250	Hose, 1/2"-1 Brd. x 18 Ft.	-	2	-	-
21	5020282	Hose, 3/4"-1 Brd. x 16 Ft.	2	-	-	-
22	5049017	Torque Chain, 24"	1	1	1	1
23	5062006	S-Hook	1	1	1	1
24	5067009	Ny. Hose Barb, 1-1/4" MNPT x 1-1/4"	1	1	1	1
	5034075	Hex Bolt, 3/8" x 1-1/4"	2	2	2	2
	5016027	Lock Washer, 3/8"	2	2	2	2
	5016030	Flat Washer, 3/8"	2	2	2	2
	5006054	Hex Nut, 3/8"	2	2	2	2
	5034083	Hex Bolt, 1/4" x 1"	2	2	2	2
	5016035	Locker Washer, 1/4"	2	2	2	2
	5006041	Hex Nut, 1/4"	2	2	2	2