

# 40' TRUSS-T BOOM PARTS BREAKDOWN

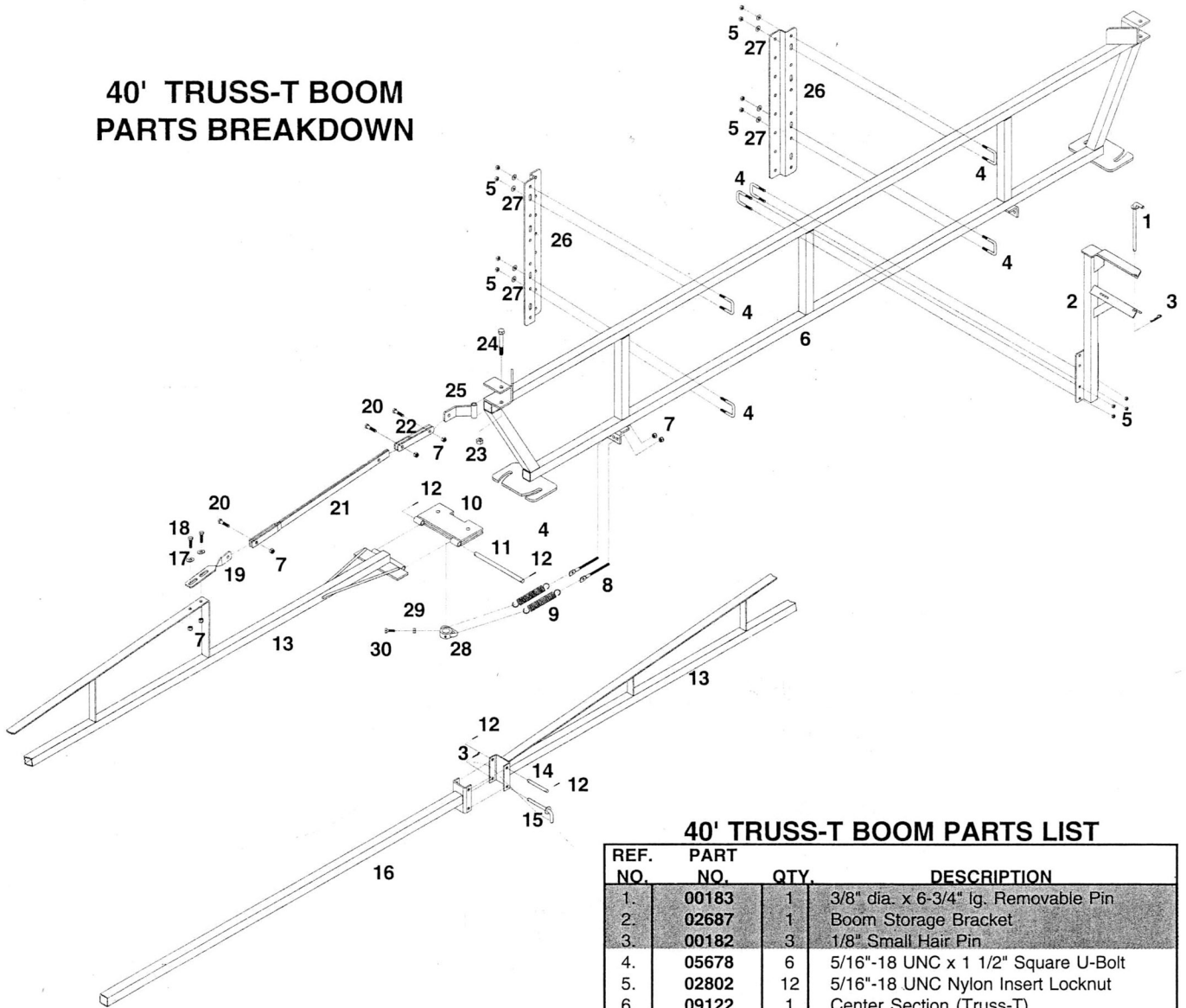

## 40' TRUSS-T BOOM PARTS LIST

REF. NO.	PART NO.	QTY.	DESCRIPTION
1.	00183	1	3/8" dia. x 6-3/4" lg. Removable Pin
2.	02687	1	Boom Storage Bracket
3.	00182	3	1/8" Small Hair Pin
4.	05678	6	5/16"-18 UNC x 1 1/2" Square U-Bolt
5.	02802	12	5/16"-18 UNC Nylon Insert Locknut
6.	09122	1	Center Section (Truss-T)
7.	02592	10	3/8"-16 UNC Nylon Insert Locknut
8.	00357	4	3/8"-16 UNC x 4-1/2" Tension Bolt
9.	00180	4	Break-Away Spring
10.	02679	2	Boom Wing Hinge
11.	00168	2	1/2" dia. x 8-3/4" lg. Hinge Pin
12.	00009	10	1/8" x 1" Cotter Pin
13.	09123	2	Boom Wing (Truss-T)
14.	00863	2	3/8" dia. x 3-1/2" lg. Hinge Pin
15.	00199	2	3/8" dia. x 4-1/2" lg. Removeable Pin
16.	09121	2	Boom Wing Extension
17.	00059	4	3/8" Flatwasher
18.	00523	6	3/8"-16 UNC x 1-1/4" Hex Head Bolt
19.	02686	2	Linkage Mount
20.	00914	4	3/8"-16 UNC x 1-1/2" Hex Head Bolt
21.	02683	2	Long Knee Action Linkage
22.	02684	2	Short Linkage
23.	02178	2	1/2"-13 UNC Nylon Insert Locknut
24.	01897	2	1/2"-13 UNC x 3 1/2" Hex Head Bolt
25.	02685	2	Linkage Pivot Arm
26.	09120	2	Boom Mounting Plate
27.	00004	8	5/16" Flatwasher
28.	00176	2	Spring Hook Collar
29.	00061	2	3/8" - 16 UNC Hex Nut
30.	00177	2	3/8" - 16 UNC x 1" Ground Hex Head Bolt